

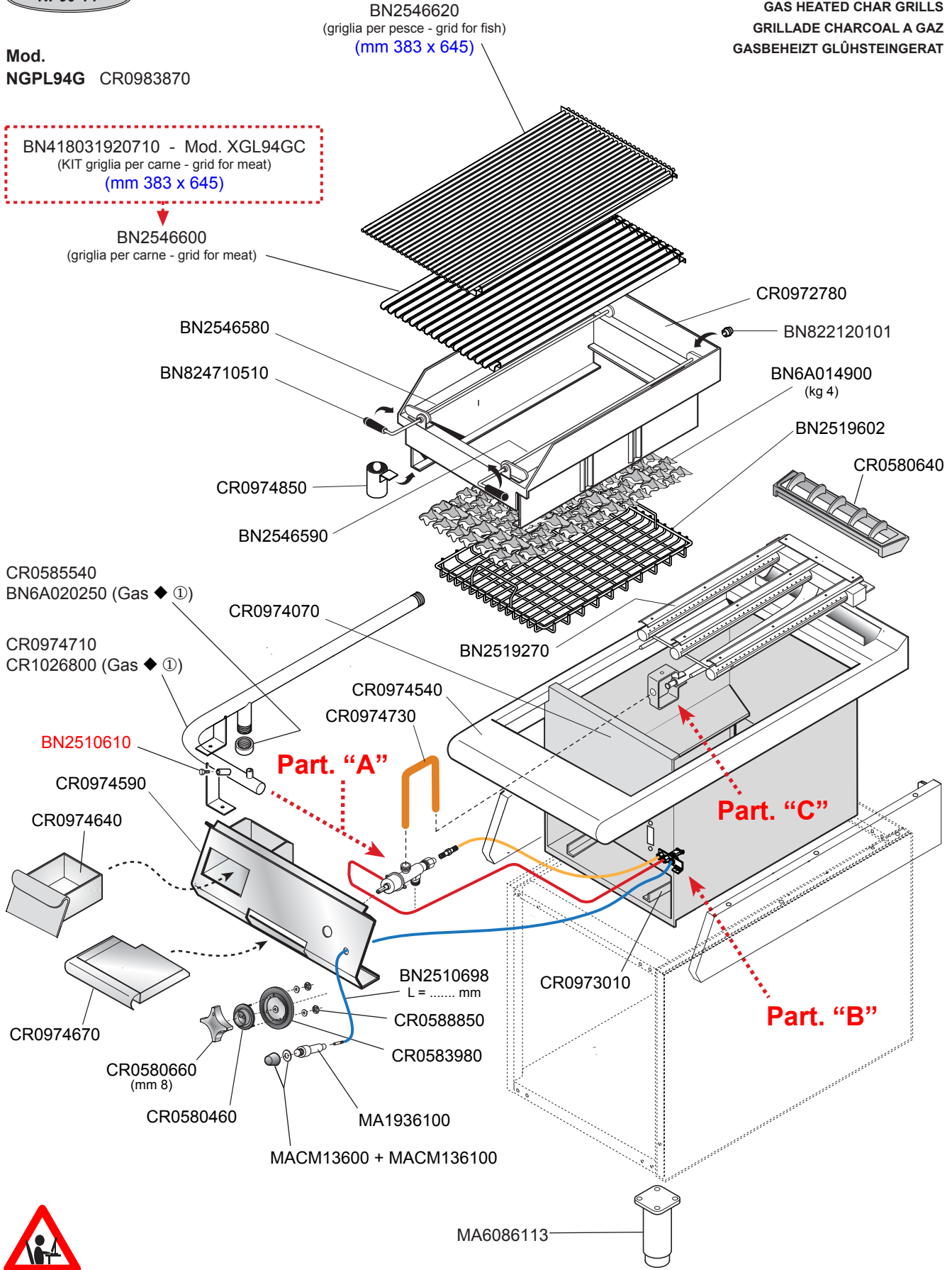

NP90-14

GRIGLIA BISTECCHIERA (A PIETRA LAVICA) A GAS
 GAS HEATED CHAR GRILLS
 GRILLADE CHARCOAL A GAZ
 GASBEHEIZT GLÜHSTEINGERAT

Mod.
NGPL94G CR0983870

BN418031920710 - Mod. XGL94GC
 (KIT griglia per carne - grid for meat)
 (mm 383 x 645)



 MARENO INDUSTRIE ALI spa Mareno di Piave (TV)	ELABORATO:	APPROVATO:	GRUPPO:	DENOMINAZIONE:		
	LZ		Serie NP90	Impianto gas e mobile		
	DATA:	DATA:	PARTICOLARE:	REV. N.	DEL	DISEGNO N.
	23 Gen 2014	23 Gen 2014	Disegno esploso per ricambi	Z00	0114	3.P.9.39 1/5
SOST. DIS.						

Mod.
NGPL94G CR0983870
NGPL98G CR0983880



Part. "A"
 PEL 21 S

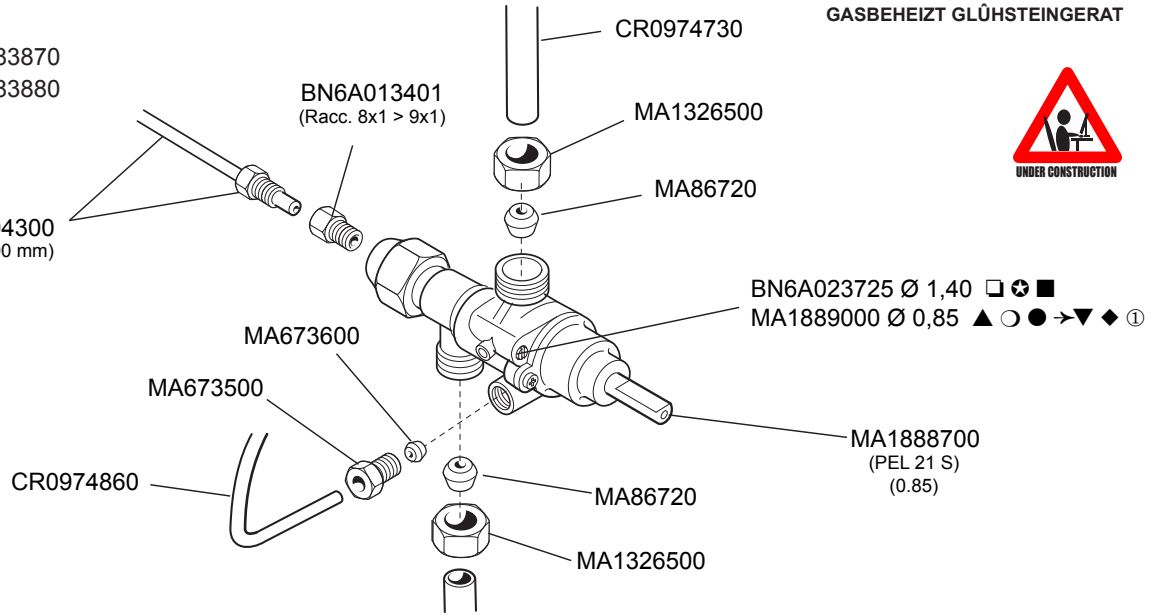

Part. "B"
 Art. 526

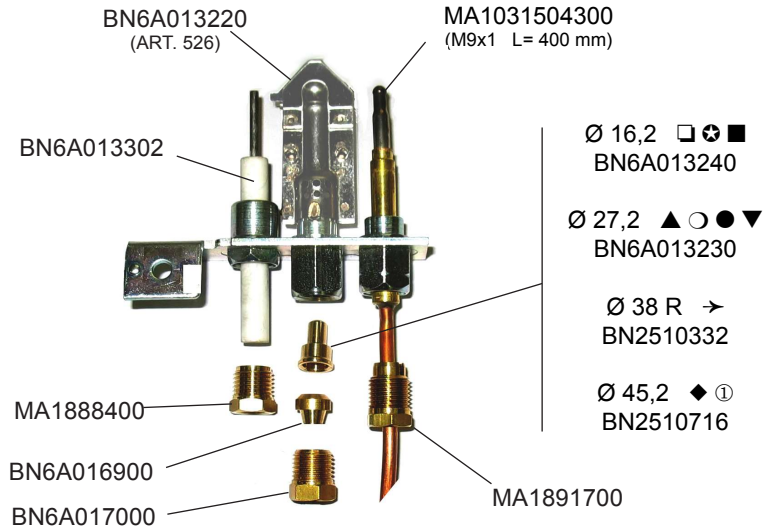

ID	GAS:
□	G30/50
☆	G30/37
■	G30/30
▲	G20/25
○	G20/20
●	G25/25
→	G25.1/25
▼	G25/20
◆	G120/8
①	G110/8

Part. "C"

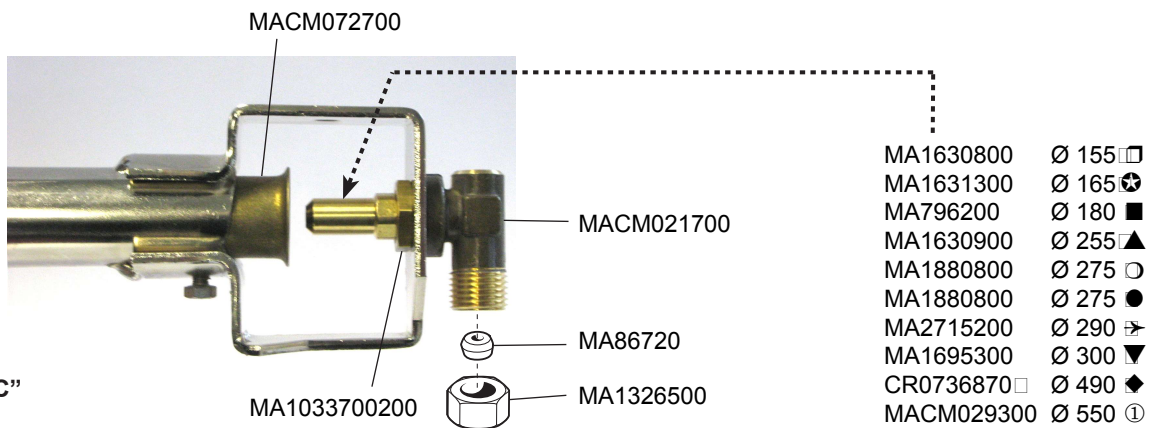

 MARENO INDUSTRIE ALI spa Mareno di Piave (TV)	ELABORATO:	APPROVATO:	GRUPPO:	DENOMINAZIONE:		
	LZ		Serie NP90	Impianto gas e mobile		
	DATA:	DATA:	PARTICOLARE:	REV. N.	DEL	DISEGNO N.
	23 Gen 2014	23 Gen 2014	Disegno esplosivo per ricambi	▼	▼	▼
SOST. DIS.			Z00	0114	3.P.9.39 2/5	

Mod.
NGPL94G CR0987270
NGPL98G CR0987280

**GAS CITTA' - GAZ DE VILLE
 TOWN GAS - STADTGAS**

G110 - G120

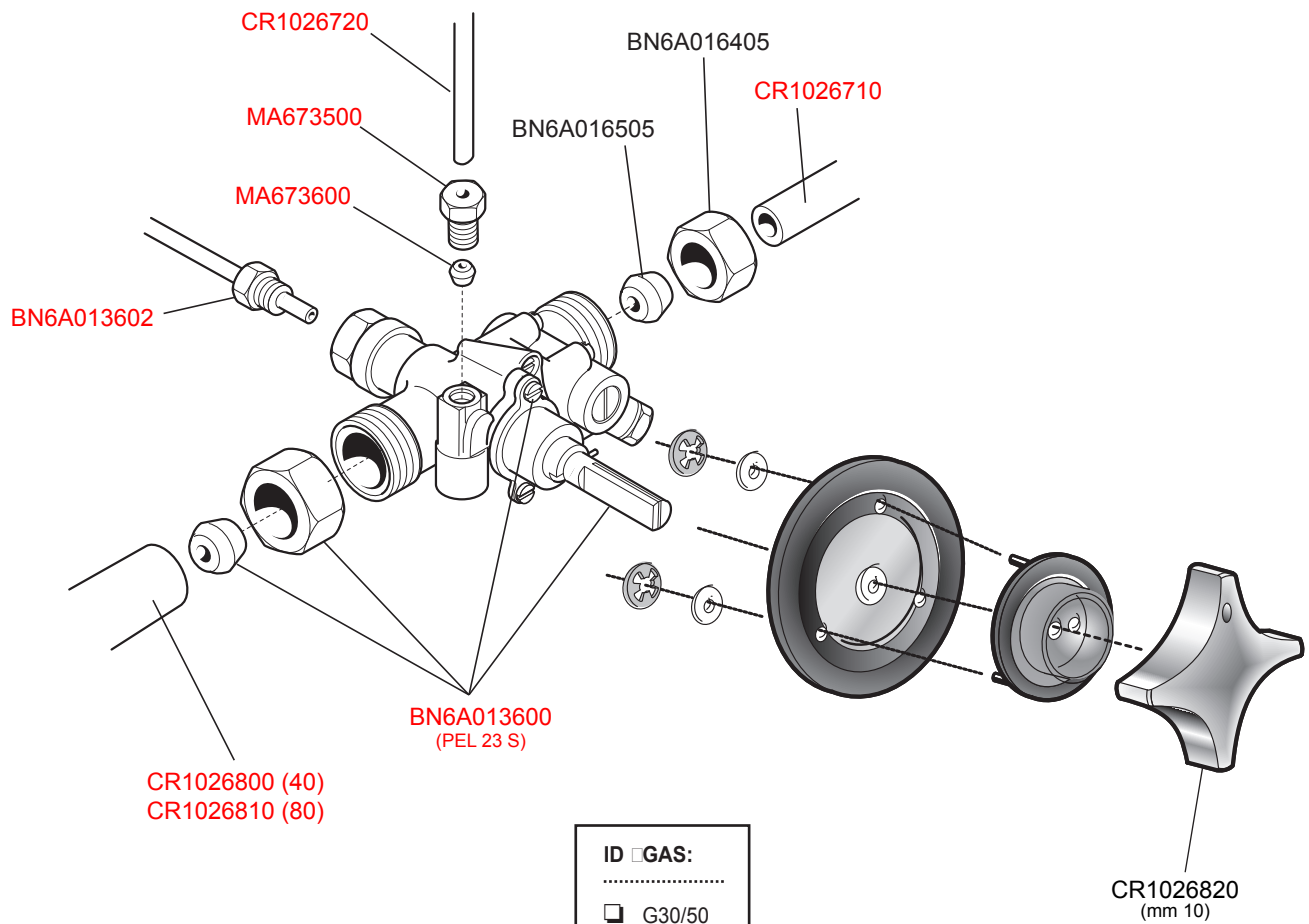

Part. "A"
PEL 23 SV
 (G110/120)

ID	GAS:
□	G30/50
⊗	G30/37
■	G30/30
▲	G20/25
○	G20/20
●	G25/25
→	G25.1/25
▼	G25/20
◆	G120/8
Ⓛ	G110/8



 MARENO INDUSTRIES ALI spa Mareno di Piave (TV)	ELABORATO:	APPROVATO:	GRUPPO:	DENOMINAZIONE:		
	LZ		Serie NP90	Impianto gas e mobile		
	DATA:	DATA:	PARTICOLARE:	REV. N.	DEL	DISEGNO N.
	23 Gen 2014	23 Gen 2014	Disegno esploso per ricambi	▼	▼	▼
SOST. DIS.			Z00	0114	3.P.9.39 3/5	

NP90-14

GRIGLIA BISTECCHIERA (A PIETRA LAVICA) A GAS
 GAS HEATED CHAR GRILLS
 GRILLADE CHARCOAL A GAZ
 GASBEHEIZT GLÜHSTEINGERAT

Mod.
NGPL94G CR0983870

BN2591910 - Mod. XGL94GG
 (KIT griglia ghisa - cast iron grid)
 (mm 383 x 645)

BN6A003470
 (griglia ghisa - cast iron grid)

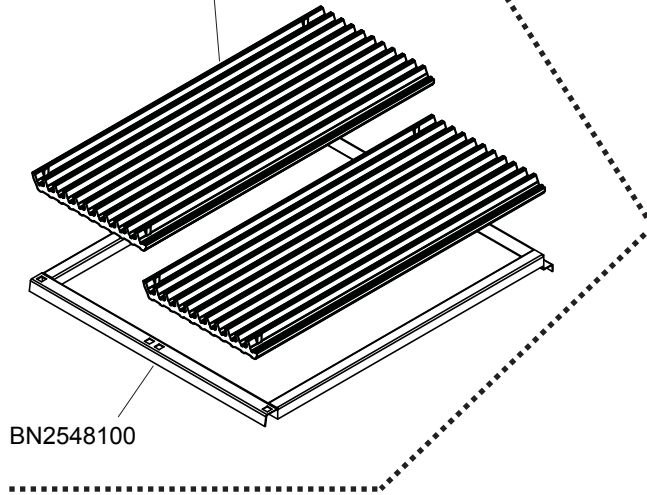

Mod.
NGPL98G CR0983880

BN2591915 - Mod. XGL98GG
 (KIT griglia ghisa - cast iron grid)
 (mm 783 x 645)

BN6A003470
 (griglia ghisa - cast iron grid)

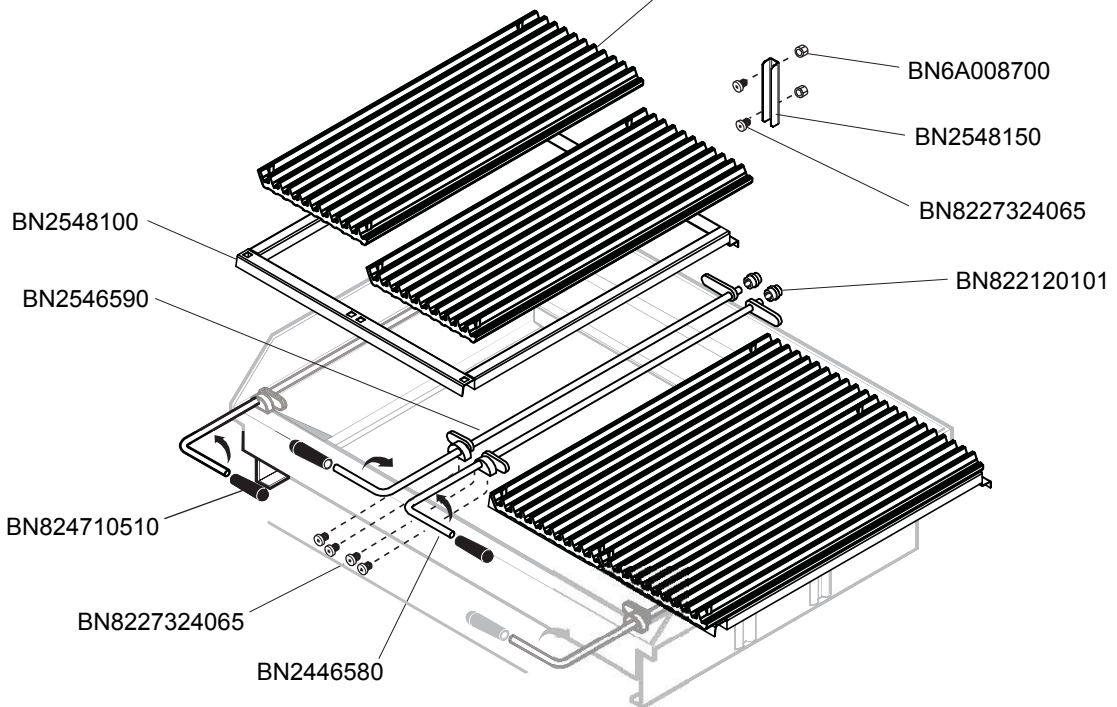

 MARENO INDUSTRIE ALI spa Mareno di Piave (TV)	ELABORATO:	APPROVATO:	GRUPPO:	DENOMINAZIONE:		
	LZ		Serie NP90	Impianto gas e mobile		
	DATA:	DATA:	PARTICOLARE:	REV. N.	DEL	DISEGNO N.
	23 Gen 2014	23 Gen 2014	Disegno esploso per ricambi	▼	▼	▼
SOST. DIS.				Z00	0114	3.P.9.39 5/5