

NP70-10

PIANI DI COTTURA GAS - FUOCHI APERTI

GAS COOKING TOPS

PLANS DE CUISSON A GAZ

GAS KOCHSTELLEN

> MA020222663 (*)

1033719600

Ø 20 □ ◆ ■

1033719700 (*)

Ø 41 ○ ◆ ◇ ● ▲

1033719800

Ø 75 + +

(☆)

SI8204760

CR0586441 (65)
(Ø 27 - 18112010)

CR0581700

Ø 65 mm - 1,5/6 kW

521411 Ø 105 □

521511 Ø 110 ◆

521611 Ø 115 ■

CR0938460 Ø 180R ◇

CR0586770 Ø 195R ○ ●

CR0586820 Ø 195K ◇

CR0586780 Ø 215R ▲

525411 Ø 320 +

525711 Ø 350 +

CR0580640

CR0592890 (INOX)

CR0580010 (65)

CR0580030 (65)

CR0688830

CR0687080

1888400

673600

673500

1891700

CM029100
(M9x1 L=850 mm)

CR0730220

459500

86720

CR0730230

1326500

86720

CR0580450 (0,90 - 65)

CR0730240
CR0730540 (NC7FE...)

CR0730250

CR0585540

CR0585490* ▶
◀ CR0585500*CR0730680* 4
CR0730620* 8
CR0730770* 12CR0583070* 4
CR0583100* 8
CR0583080* 12

CR0580660 (Ø 8)

CR0580460

CR0583990 ▲
CR0583980 ▼1936100
CM136000
CR0688770

Ø 65 (1,5 - 6 kW)

CR0586840 - Ø 0,65 □ ◆ ■

1033720200 - Ø 0,90 ○ ◆ ◇ ● ▲ + +

Mod.

NC74G12*

NC78G24*

NC712G36*

NC7FG8G32

NC7FG12G44

CR0598000

CR0598010

CR0598020

CR0598090

CR0598100

Mod.

NC7FGM12G

NT7FG12G

NS78GS

NS7FG12GS

NC7FE8G24

NC7FE12G36

CR0598160

CR0598310

CR0599680

CR0599750

CR0598140

CR0598150

ID GAS: □ G30/50 ◆ G30/37 ■ G30/29 ○ G20/20 ◇ G20/25 ● G25/25 ⊕ G25.1/25 ▲ G25/20 + G120/8 + G110/8

MARENO ALI spa
Mareno di Piave (TV)

ELABORATO:

LZ

APPROVATO:

GRUPPO:

Cucine Serie NP70

DENOMINAZIONE:

Impianto gas e mobile

DATA:

26 Mar 2012

DATA:

26 Mar 2012

PARTICOLARE:

Disegno esploso
per ricambi

REV. N.

Z10

DEL

0312

DISEGNO N.

3.P7.01

SOST. DIS.



NP70-10

Mod.
NS78GS CR0599680
NS7FG8GS CR0599750

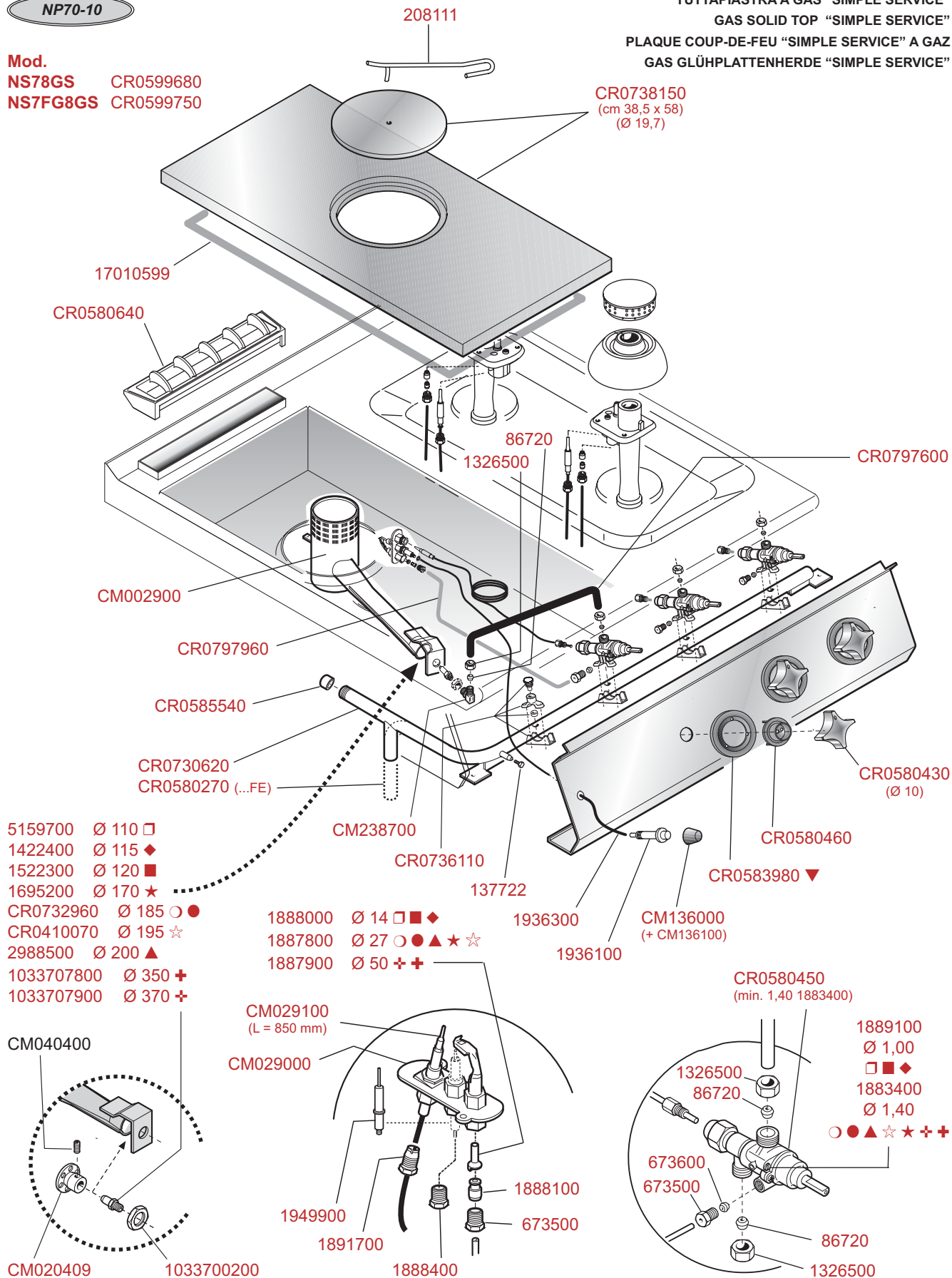
TUTTAPIASTRA A GAS "SIMPLE SERVICE"
GAS SOLID TOP "SIMPLE SERVICE"
PLAQUE COUP-DE-FEU "SIMPLE SERVICE" A GAZ
GAS GLÜHPLATTENHERDE "SIMPLE SERVICE"



ID GAS: □ G30/50 ■ G30/28+37 ◆ G30+31/37 ○ G20/20 ★ G20/25 ● G25/25 ☆ G25.1/25 ▲ G25/20 + G110/8 ++ G120/8

| | | | | | | |
|--|---|-------------|-----------------------------|-----------------------|--------|------------|
|  MARENO INDUSTRIE ALI spa Mareno di Piave (TV) | ELABORATO: | APPROVATO: | GRUPPO: | DENOMINAZIONE: | | |
| |  | | Cucine Serie NP70 | Impianto gas e mobile | | |
| | DATA: | DATA: | PARTICOLARE: | REV. N. | DEL | DISEGNO N. |
| | 11 Nov 2010 | 11 Nov 2010 | Disegno esploso per ricambi | ▼ Z00 | ▼ 1110 | ▼ 3.P.56 |
| | SOST. DIS. | | | | | |

NP70-10

FORNI A GAS
GAS OVENS
FOURS A GAZ
GAS BACKOFEN

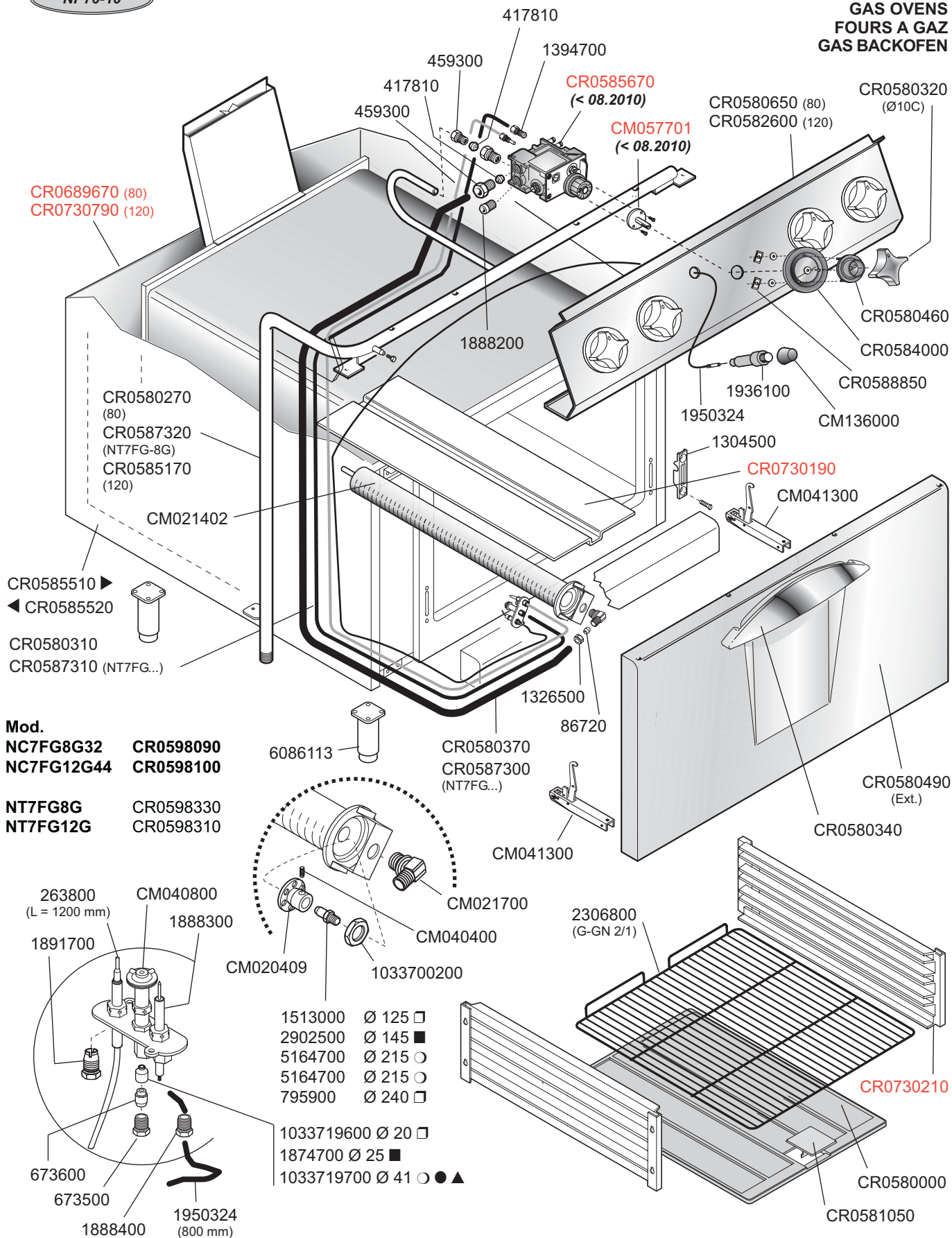

ID GAS:

□ G30/50

■ G30/29

○ G20/20

● G25/25

▲ G25/20

✱ G120/8

✱ G110/8



MARENO INDUSTRIE ALI spa
Mareno di Piave - TV

ELABORATO:

LZ

APPROVATO:

GRUPPO:

Forno Serie NP70

DENOMINAZIONE:

Impianto gas e mobile

DATA:

28 Gen 2010

DATA:

28 Gen 2010

PARTICOLARE:

Disegno esploso
per ricambi

REV. N.

Z00

DEL

0110

DISEGNO N.



3.P70.02 1/2

SOST. DIS.

NP70-10

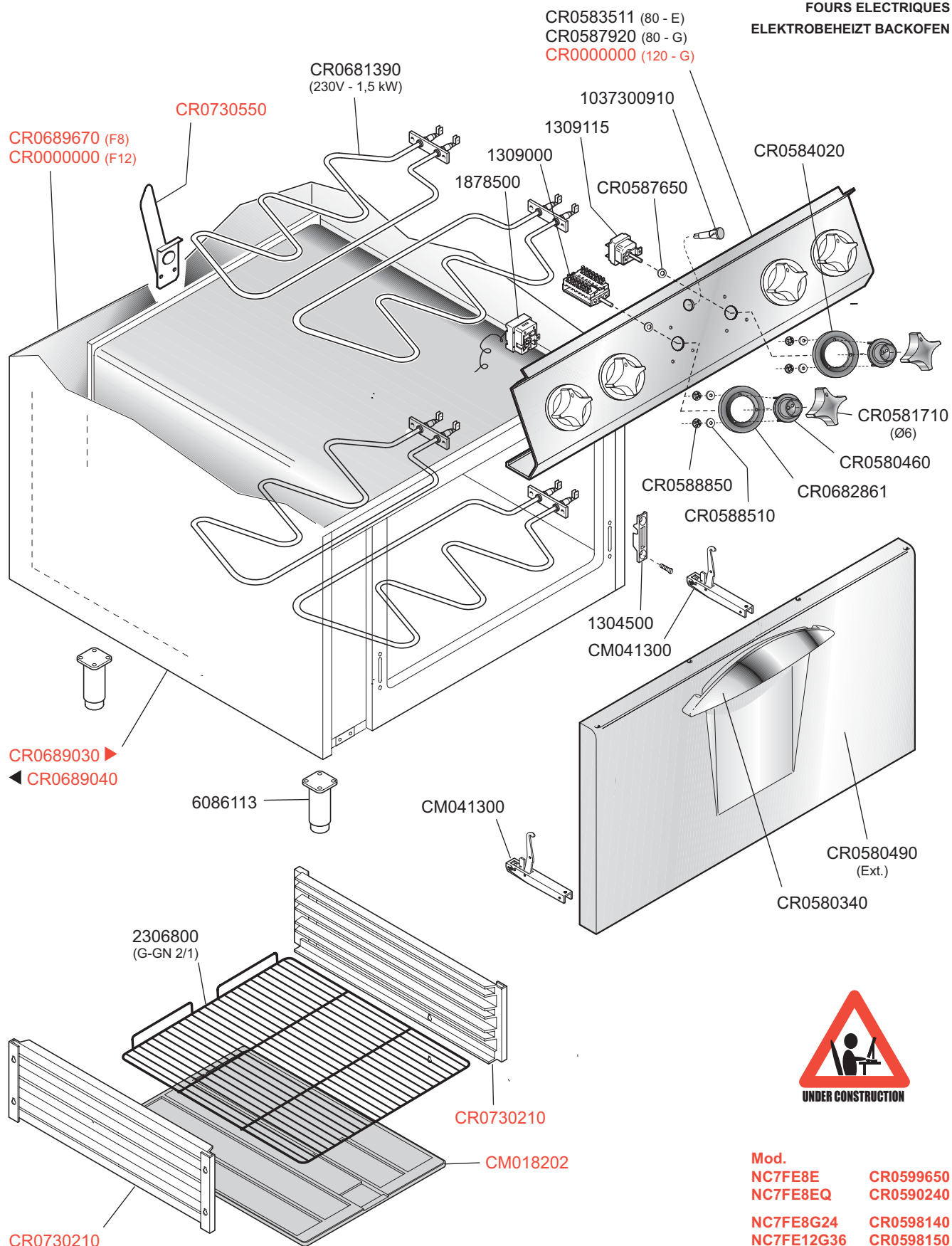
FORNI ELETTRICI
ELECTRIC-HEATED OVENS
FOURS ELECTRIQUES
ELEKTROBEHEIZT BACKOFEN



| | | | | | | |
|--|---|-------------|-----------------------------|-----------------------------|------|------------|
|  MARENO INDUSTRIE ALI spa Mareno di Piave (TV) | ELABORATO: | APPROVATO: | GRUPPO: | DENOMINAZIONE: | | |
| |  | | Forno Serie NP70 | Impianto elettrico e mobile | | |
| | DATA: | DATA: | PARTICOLARE: | REV. N. | DEL | DISEGNO N. |
| | 29 Gen 2010 | 29 Gen 2010 | Disegno esploso per ricambi | Z00 | 0810 | 3.P70.03 |
| | SOST. DIS. | | | | | |

NP70-10

**FORNO A GAS MAXI
GAS MAXI OVEN
MAXI FOUR A GAZ
"MAXI" GAS BACKOFEN**

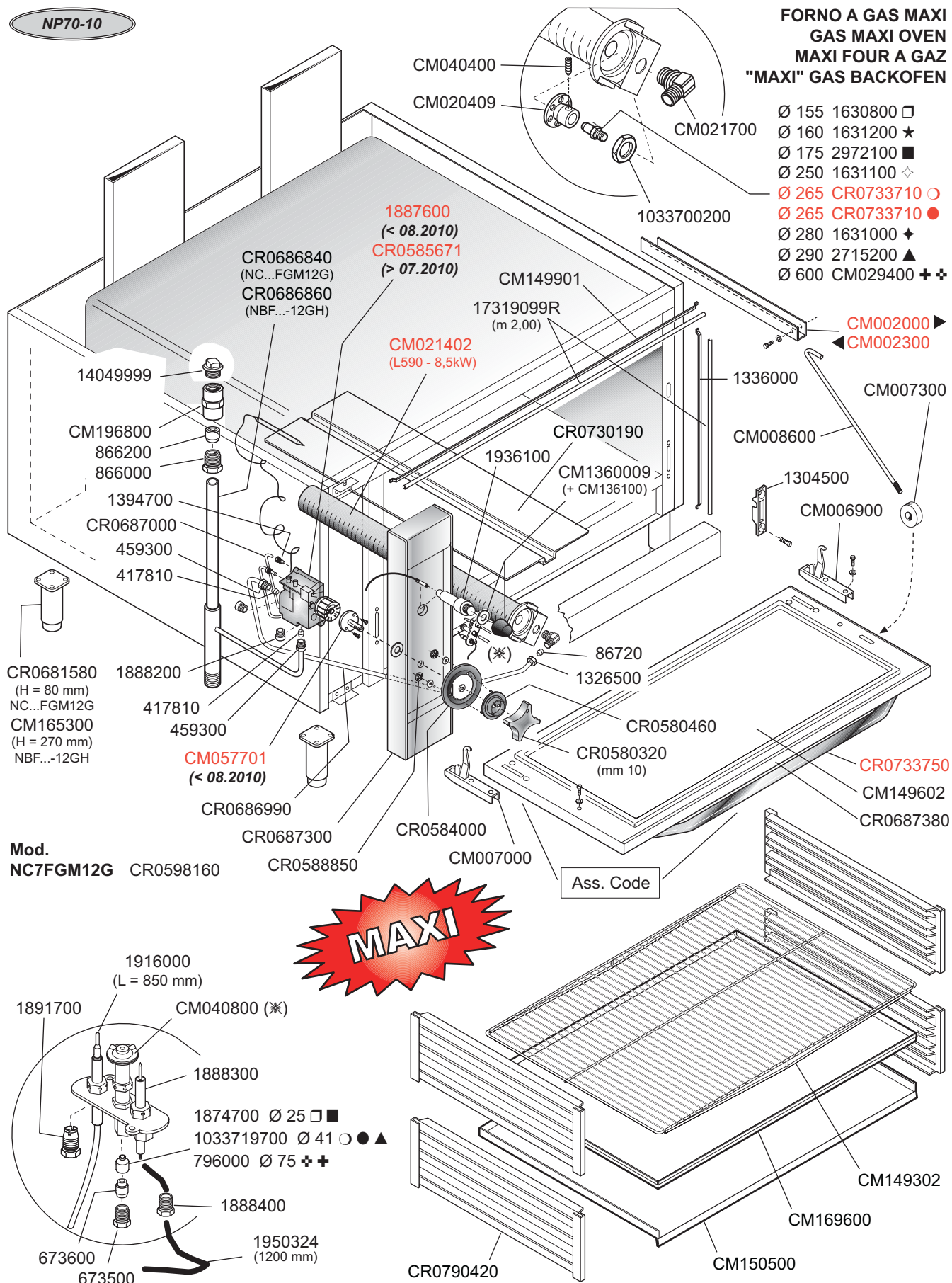

ID GAS: □ G30/50 ★ G30.31/37 ■ G30/29 ○ G20/20 ◇ G20/25 ● G25/25 ✚ G25.1/25 ▲ G25/20 ✚ G120/8 ✚ G110/8

| | | | | | | |
|--|---|-------------|---|-----------------------|--------|----------------|
|  MARENO INDUSTRIE ALI spa Mareno di Piave (TV) | ELABORATO: | APPROVATO: | GRUPPO: | DENOMINAZIONE: | | |
| |  | | Serie forno MAXI NP70 | Impianto gas e mobile | | |
| | DATA: | DATA: | PARTICOLARE: | REV. N. | DEL | DISEGNO N. |
| | 15 Feb 2010 | 15 Feb 2010 | Disegno esploso per ricambi | ▼ Z00 | ▼ 0210 | ▼ 3.P70.47 1/2 |
| SOST. DIS. | | |  | | | |