

STEAMER FG 101 / PG 081 - 101 - AC 230 V

CODE	PIECES M X	DESCRIPTION
R02200280	1 1	DRAIN FILTER
R04201500	1 1	DOOR
R04400580	0 2	LIGHT PROTECTION
R04403460	1 1	CHAMBER VENT PLATE Ø 46
R04403620	1 1	INNER DOOR PANEL
R09200230	1 1	DOOR HANDLE
R10100110	1 1	PRONG FLANGE
R58002160	1 1	DOOR HANDLE PRONG PIN
R58002760	1 1	DOOR HANDLE PRONG COUPLER
R58003240	1 1	DOOR HANDLE BUTTON ROD
R58003270	1 1	CHAMBER VENT ROD
R58003840	1 1	MOTOR GASKET BRASS FLANGE
R58003850	1 1	MOTOR GASKET BRASS COUNTER FLANGE
R58004000	1 1	FAN SCREW M12x1.5 SX
R58004010	1 1	FAN WASHER Ø 30/12.5
R58004270	1 1	DOOR HANDLE SPACER
R58004830	1 1	RING NUT M18x1
R58005050	1 1	DOOR HANDLE PRONG
R58005190	1 1	STEAM OUTLET KNOB
R58005340	1 1	DOOR HANDLE LOWER INSULATION WASHER
R58005350	1 1	DOOR HANDLE UPPER INSULATION WASHER
R58005700	1 1	CHAMBER DRAIN CUP
R61020562	1 1	FAN SCREW TE A2 M6x55
R61620012	1 1	DOOR HANDLE CATCH SPRING
R61620041	1 1	DOOR HANDLE BUTTON SPRING
R61630031	2 2	METAL CLAMPS 40-60/9
R63015280	2 2	BURNER
R63020150	1 1	GAS SOLENOID VALVE
R63050060	2 2	IGNITOR
R63060100	1 1	BURNER IGNITION PANEL S456 AF 1007
R65040031	0 1	MOTOR HP 1/0.3 KIT
R65040041	1 0	MOTOR HP 1 KIT
R65070060	1 1	SAFETY THERMOSTAT
R65070210	1 1	CABINET THERMOSTAT 50/270°C
R65080010	1 1	MAIN SELECTOR SWITCH
R65090020	1 1	TIMER
R65090190	1 1	REVERSING SWITCH 8'
R65110010	1 1	SOLENOID VALVE 220V 50HZ
R65140550	2 4	CONTACTOR DIL 00 M-01 4KW
R65160430	1 0	THERMIC SWITCH SUPPORT
R65160450	0 1	THERMIC PROTECTION 0,6-1A
R65160460	1 1	THERMIC PROTECTION 1.6-2.5A
R65180430	0 1	TRANSFORMER 40VA
R65190020	1 1	CAPACITOR 16 µF
R65190090	0 1	CAPACITOR 12,5 µF
R65200200	1 1	FUSE 2A
R65200350	0 1	FUSE 0.4A (T)
R65210020	1 2	FUSE CARRIER
R65220220	1 1	TERMINAL BOARD
R65260050	0 1	SWITCH
R65260210	0 1	CURRENT EXCHANGE SWITCH
R65260510	1 1	HUMIDIFIER PUSH BUTTON
R65260480	1 1	UNIPOLAR PUSH BUTTON
R65260540	1 1	DOOR SWITCH
R65270020	0 2	LIGHT 20W 12V G4
R65270220	2 2	ORANGE INDICATING LIGHT
R65270230	2 2	GREEN INDICATING LIGHT
R65270400	0 2	LIGHT SOCKET
R65280130	1 1	INTERFERENCE SUPPRESSOR
R65280210	1 1	INTERFERENCE SUPPRESSOR
R65330010	1 1	BUZZER
R65340050	1 1	THERMOMETER
R66605840	2 2	FLAME IGNITION CABLE/FLAME SENSOR CABLE
R67010320	1 0	LAINOX PLATE F/105-210 M LX
R67010330	0 1	LAINOX PLATE F/105-210 X LX
R69015000	1 1	DOOR HANDLE ASSEMBLY
R69030150	3 3	KNOB KIT
R69031190	1 1	DOOR HANDLE PUSH BUTTON
R69070050	4 4	FOOT 1" 1/4
R70020050	1 1	MOTOR GASKET
R70030090	2 2	NOZZLE GASKET
R70040120	2 2	GLASS GASKET
R70041550	1 1	DOOR GASKET
R70050020	6 6	KNOB GASKET
R70050050	1 1	DRAIN CAP GASKET
R70060040	1 1	SILICON COUPLING Ø 50
R71030120	1 1	DOOR GLASS
R75400340	1 1	FAN Ø 350x100/24 50HZ P.D. KIT

A NOZZLE (see Service Manual)

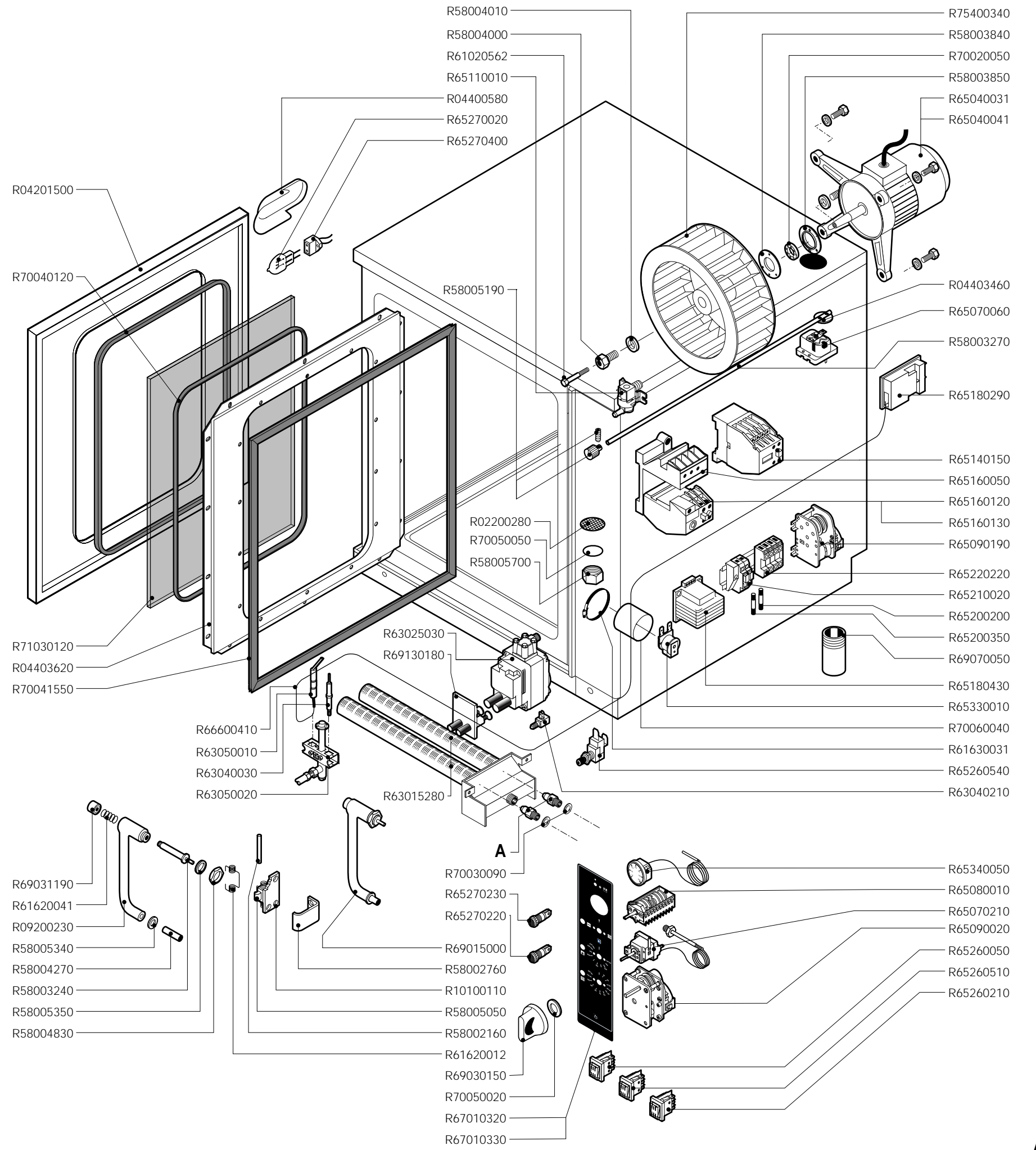

STEAMER FG 101 / PG 081 - 101 - AC 230 V

CODE	PIECES M X	DESCRIPTION
R02200280	1 1	DRAIN FILTER
R04201500	1 1	DOOR
R04400580	0 2	LIGHT PROTECTION
R04403460	1 1	CHAMBER VENT PLATE Ø 46
R04403620	1 1	INNER DOOR PANEL
R09200230	1 1	DOOR HANDLE
R10100110	1 1	PRONG FLANGE
R58002160	1 1	DOOR HANDLE PRONG PIN
R58002760	1 1	DOOR HANDLE PRONG COUPLER
R58003240	1 1	DOOR HANDLE BUTTON ROD
R58003270	1 1	CHAMBER VENT ROD
R58003840	1 1	MOTOR GASKET BRASS FLANGE
R58003850	1 1	MOTOR GASKET BRASS COUNTER FLANGE
R58004000	1 1	FAN SCREW M12x1.5 SX
R58004010	1 1	FAN WASHER Ø 30/12.5
R58004270	1 1	DOOR HANDLE SPACER
R58004830	1 1	RING NUT M18x1
R58005050	1 1	DOOR HANDLE PRONG
R58005190	1 1	STEAM OUTLET KNOB
R58005340	1 1	DOOR HANDLE LOWER INSULATION WASHER
R58005350	1 1	DOOR HANDLE UPPER INSULATION WASHER
R58005700	1 1	CHAMBER DRAIN CUP
R61020562	1 1	FAN SCREW TE A2 M6x55
R61620012	1 1	DOOR HANDLE CATCH SPRING
R61620041	1 1	DOOR HANDLE BUTTON SPRING
R61630031	2 2	METAL CLAMPS 40-60/9
R63015280	2 2	BURNER
R63025030	1 1	GAS SOLENOID VALVE
R63040030	1 1	THERMOCOUPLE
R63040210	1 1	THERMOCOUPLE CONNECT.
R63050010	1 1	SPARK PLUG
R63050020	1 1	PILOT BURNER
R65040031	0 1	MOTOR HP 1/0.3 KIT
R65040041	1 0	MOTOR HP 1 KIT
R65070060	1 1	SAFETY THERMOSTAT
R65070210	1 1	CABINET THERMOSTAT 50/270°C
R65080010	1 1	MAIN SELECTOR SWITCH
R65090020	1 1	TIMER
R65090190	1 1	REVERSING SWITCH 8'
R65110010	1 1	SOLENOID VALVE 220V 50HZ
R65140150	2 4	CONTACTOR 3TF4011-OAUO 240V
R65160050	1 0	THERMIC SWITCH SUPPORT 3UX1418
R65160120	0 1	THERMIC PROTECTION 3UA5000-1C 1.6-2.5 A
R65160130	1 1	THERMIC PROTECTION 3UA5000-1C 3.2-5 A
R65180290	1 1	SPARK IGNITER
R65180430	0 1	TRANSFORMER 40VA
R65200200	1 1	FUSE 2A
R65200350	0 1	FUSE 0.4A (T)
R65210020	1 2	FUSE CARRIER
R65220220	1 1	TERMINAL BOARD
R65260050	0 1	SWITCH
R65260210	0 1	CURRENT EXCHANGE SWITCH
R65260510	1 1	HUMIDIFIER PUSH BUTTON
R65260540	1 1	DOOR SWITCH
R65270020	0 2	LIGHT 20W 12V G4
R65270220	2 2	ORANGE INDICATING LIGHT
R65270230	2 2	GREEN INDICATING LIGHT
R65270400	0 2	LIGHT SOCKET
R65330010	1 1	BUZZER
R65340050	1 1	THERMOMETER
R66600410	1 1	SPARK PLUG CABLE
R67010320	1 0	LAINOX PLATE F/105-210 M LX
R67010330	0 1	LAINOX PLATE F/105-210 X LX
R69015000	1 1	DOOR HANDLE ASSEMBLY
R69030150	3 3	KNOB KIT
R69031190	1 1	DOOR HANDLE PUSH BUTTON
R69070050	4 4	FOOT 1" 1/4
R69130180	1 1	VALVE FRONTAL COVER
R70020050	1 1	MOTOR GASKET
R70030090	2 2	NOZZLE GASKET
R70040120	2 2	GLASS GASKET
R70041550	1 1	DOOR GASKET
R70050020	6 6	KNOB GASKET
R70050050	1 1	DRAIN CAP GASKET
R70060040	1 1	SILICON COUPLING Ø 50
R71030120	1 1	DOOR GLASS
R75400340	1 1	FAN Ø 350x100/24 50HZ P.D. KIT

A NOZZLE (see Service Manual)