

MODEL: ABV3038

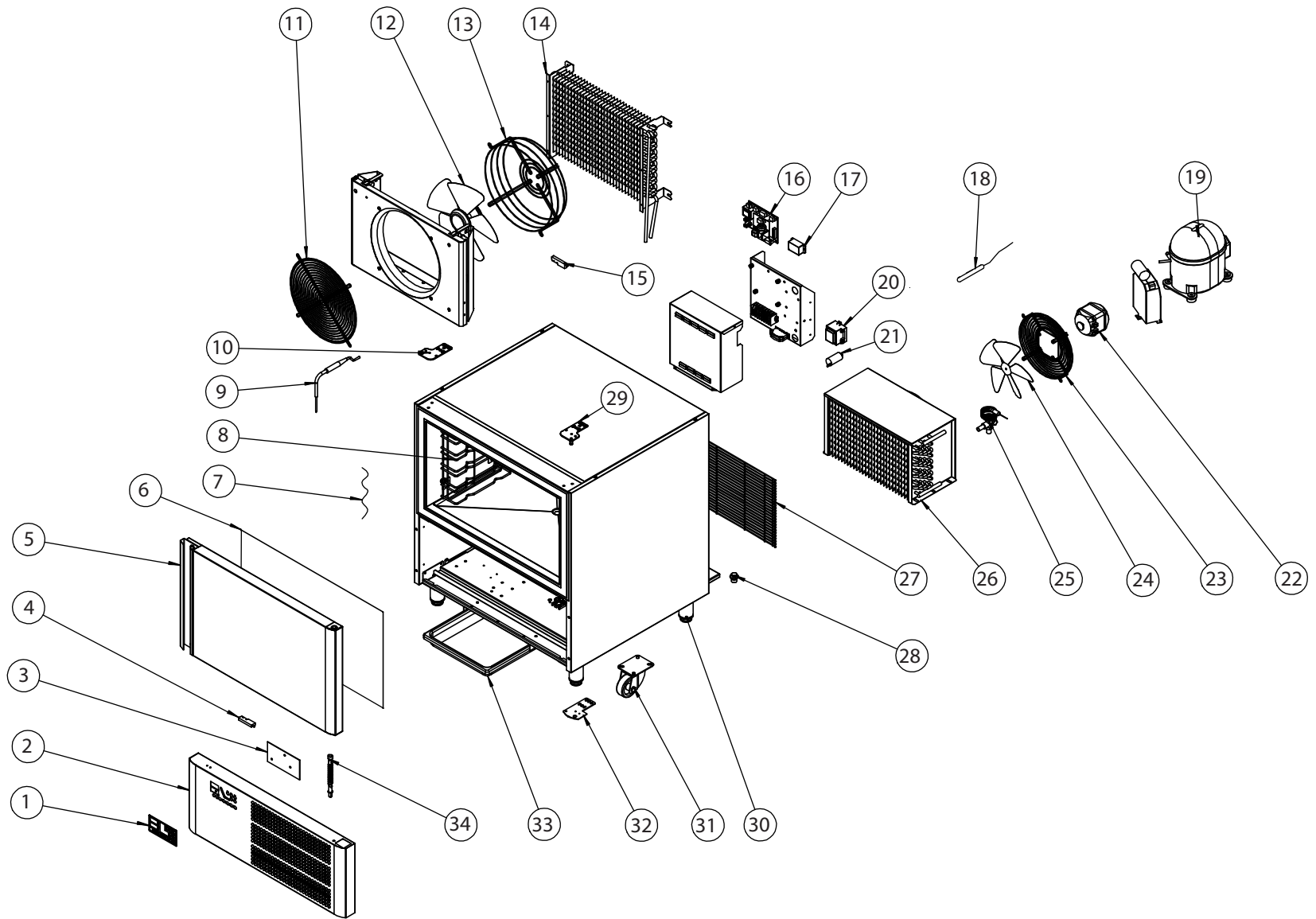

NR	COD	ITALIANO	ENGLISH	FRANCAIS	DEUTSCHE
1	33216	MEMBRANA ABB. ORIZZ. POSITIVO	CONTROL PLATE	Plaque de controle	Bedienfeld Schockfroster positiv
3	28707	SCHEDA INTERF. PROGR. ABB. CT1MA0210001	Interface card	Fiche interface	Schnittstellenkarte
4	18762	SENSORE MAGNETICO N.O. 100W	Magnetic sensor	Capteur magnétique	Magnetsensor
5	29751	ASSIEME SCHIUMATO PORTA ABB. 5T	Door foam assembly	Ensemble porte	Verschäumtes Türset
6	29715	GUARNIZIONE MAGNETICA PORTA ABB. 5T	Door gasket	Joint magnétique porte 700	Türdichtung 700
7	29789	RESISTENZA STIPITE L=3300 (L.Z.CALDA=230	Door heating element	Résistance montant	Türrahmeneizung
8	30469	PORTATEGLIE ABBATTITORE 5T	Rack	Cremaillere	Stange
9	30599	SONDA SPILLONE ABBATTITORE L=1.2	Core probe	Sonde à coeur	Kerntemperaturfühler
11	29740	GRIGLIA VENTILATORE EVAPORATORE	Fan evaporator grid	Grille ventilateur evapourateur	Ventilator-Gitter
12	31311	MOTOVENTILATORE A4E315-AC08-19	Ventilator	Moteur	Ventilator
13	30223	GRIGLIA FRONTALE ø315 Cod. PR0081	Frontal panel grating ø315 Cod. PR0081	Grille frontal	Frontgitter
14	33742	EVAP. 13T 3R 450 P5 2 CIRCUITI	Evaporator	Evaporateur	Verdampfer
15	30458	SENSORE MAGNETICO F800 1B DA 0 097 10W	Magnetic sensor	Capteur magnétique	Magnetsensor
16	32502	SCHEDA ELETT.(CT1MA0200300-CT1MA0420000)	Power board	Fiche puissance	Leistungskarte Vertikal-Schockfroster
17	27597	RELE' T92P7A22-240 PANEL COMPONENT	Relay	Relais	Relais
18	29799	SONDA TEMPERATURA PTC Lunghezza Cavo L=1	Temperature sensor cabinet/evaporator	Sonde temperat. Chambre/evap.	Temperaturfühler
19	32712	COMPRESSORE ACC MX18FB 230 V 50Hz	Compressor	Compresseur	Kompressor
20	30605	TRASF. 165/M 20VA 230V/12V ABB.	Transformer	Transformateur	Transformator
21	31312	CONDENSATORE ELETTRICO 3uF	Condenser	Condenseur	Kondensator 240 A
22	29744	MOTOVENT. M4Q 045-EA01-01 (25W) ZIEHL	Ventilator	Moteur	Ventilator
23	30329	GRIGLIA CONDENSATORE 9906	Fan protection grid	Grille de protection	Schutzgitter
24	18640	VENTOLA VA D.230-28 A 73811-2-3634	Fan	Hélice	Ventil
25	34658	VALV. TERMOSTATICA TS2	EXPANSION VALVE TS2	Valve thermostatique TS2	Thermostatventil TS2
26	31728	CONDENSATORE 10T 3R 400A 3,6	Condenser	Condenseur	Kondensator
29	29133	ASS.CERNIERA SUPERIORE DX TAR	TOP RH HINGE ASSEMBLY FOR REFRIGERATED COUNTER	Ass. Charnière supérieure droite tar	rechtes oberes Scharnierset TAR
30	29795	PIEDE REGOL. INOX 1¼ C/PIASTRA H=100	Adjustable Foot	Pieds réglable	Edelstahlfuß
32	29760	ASSIEME CERNIERA INFER. ABB. 5T	Lower hinge	Charnière inferieure	Unteres Scharnierset
33	27754	ASS.BACINELLA POLISTIROLO ALIMENTARE	BASIN ASSEMBLY IN ALYMENTARY POLYSTYRENE	Ass. Bac en polystyrène alimentaire	Kunststoff Wasser-Behälter
34	14841	ASS.MOLLA DX. TAV. REFR.	Right spring assembly	Ensemble ressort droit	Feder-Set rechts