

ESPLOSO ARMADI ECO

EXPLODED VIEWS OF REFRIGERATED CABINETS

planet
planeeco



ESU0111FJ

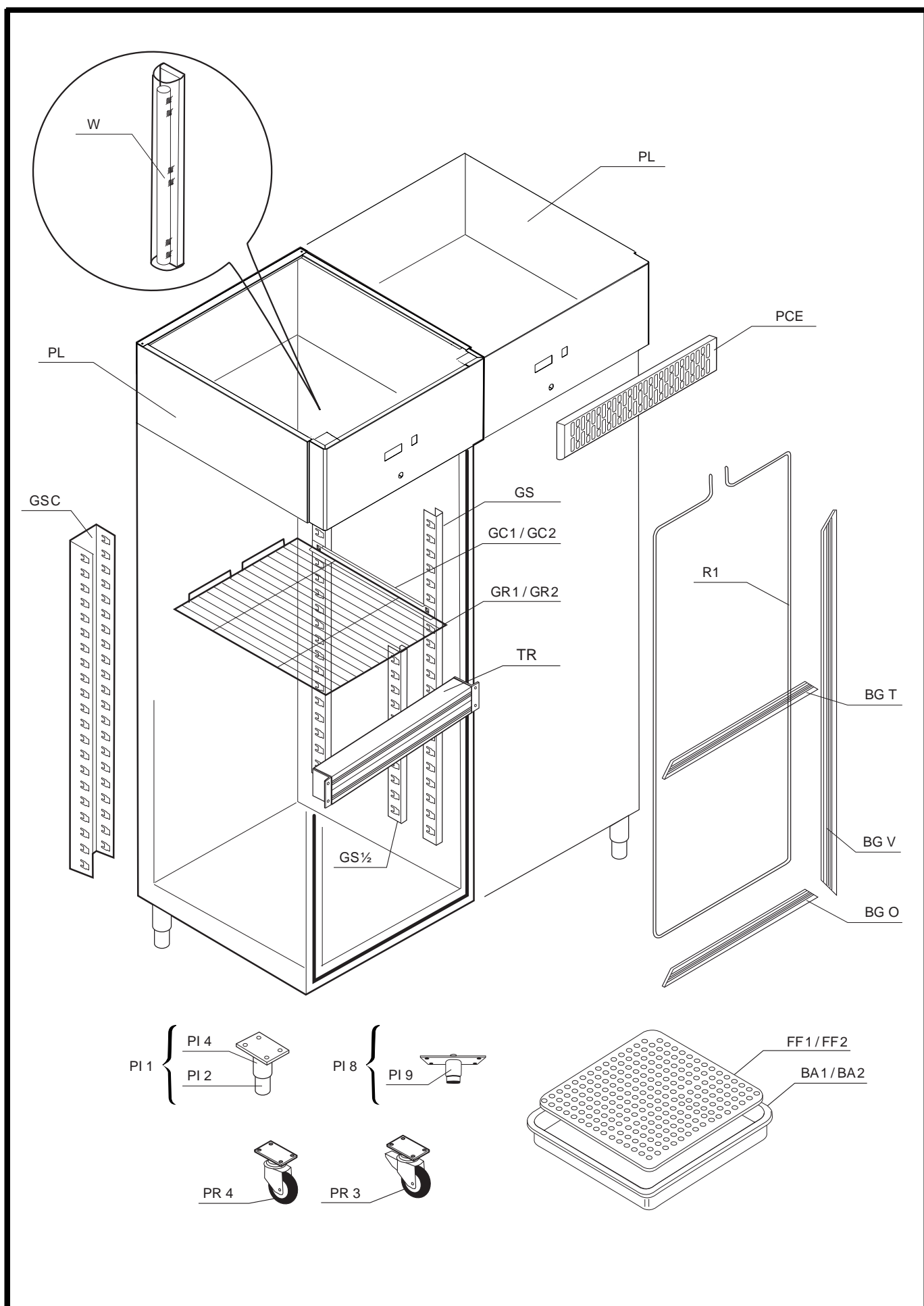

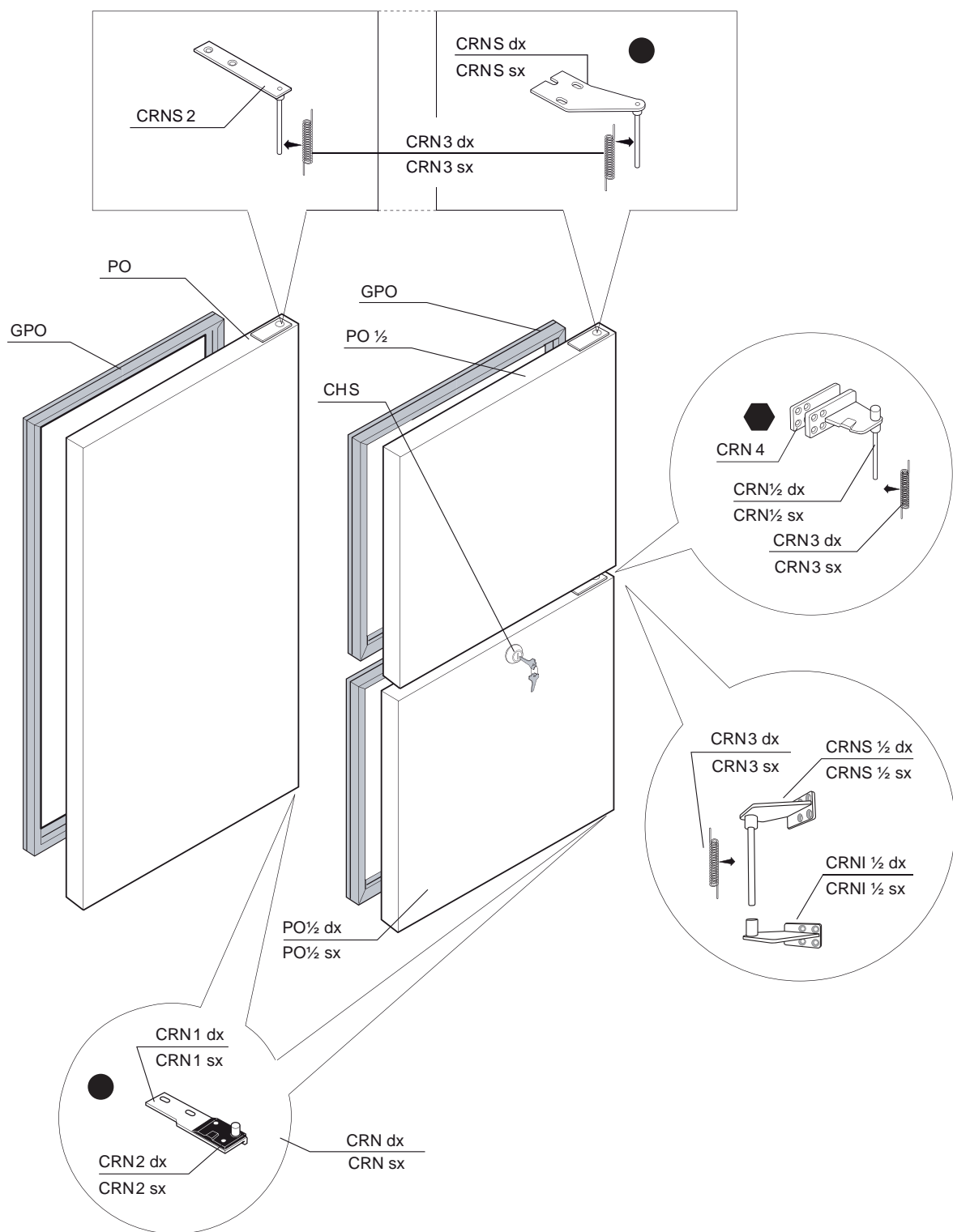

PO - PO 1/2

a

b

c

kit CRN

kit CRN IPO

kit CRN IP 1/2

kit CRN IPV



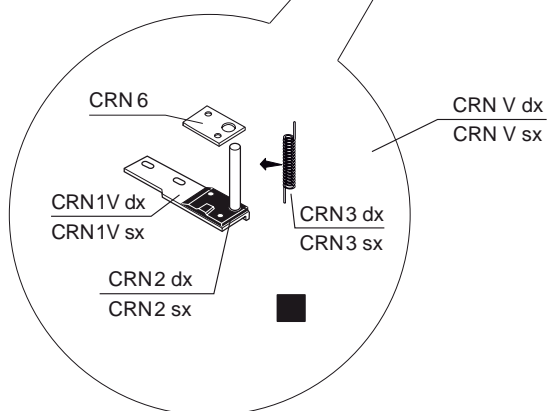
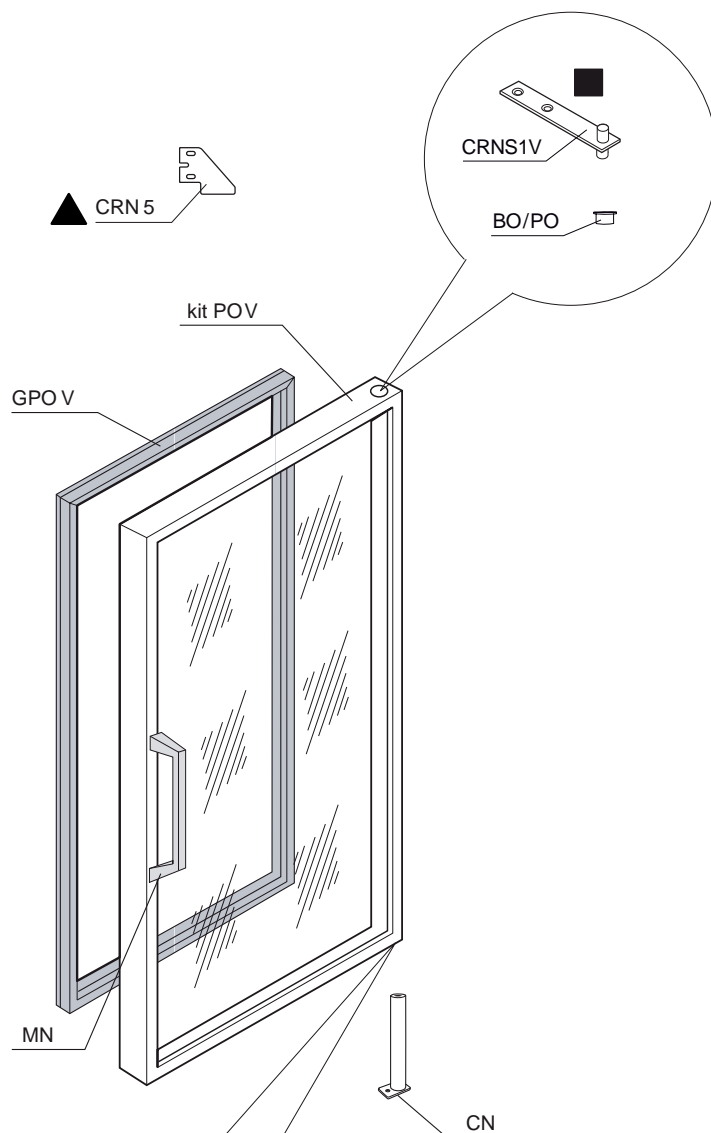

PO VTR

kit CRN

kit CRN IPO ---- ● + ▲ +
 kit CRN IP^{1/2} ---- ● + ▲ +
 kit CRN IPV ---- ■ + ▲

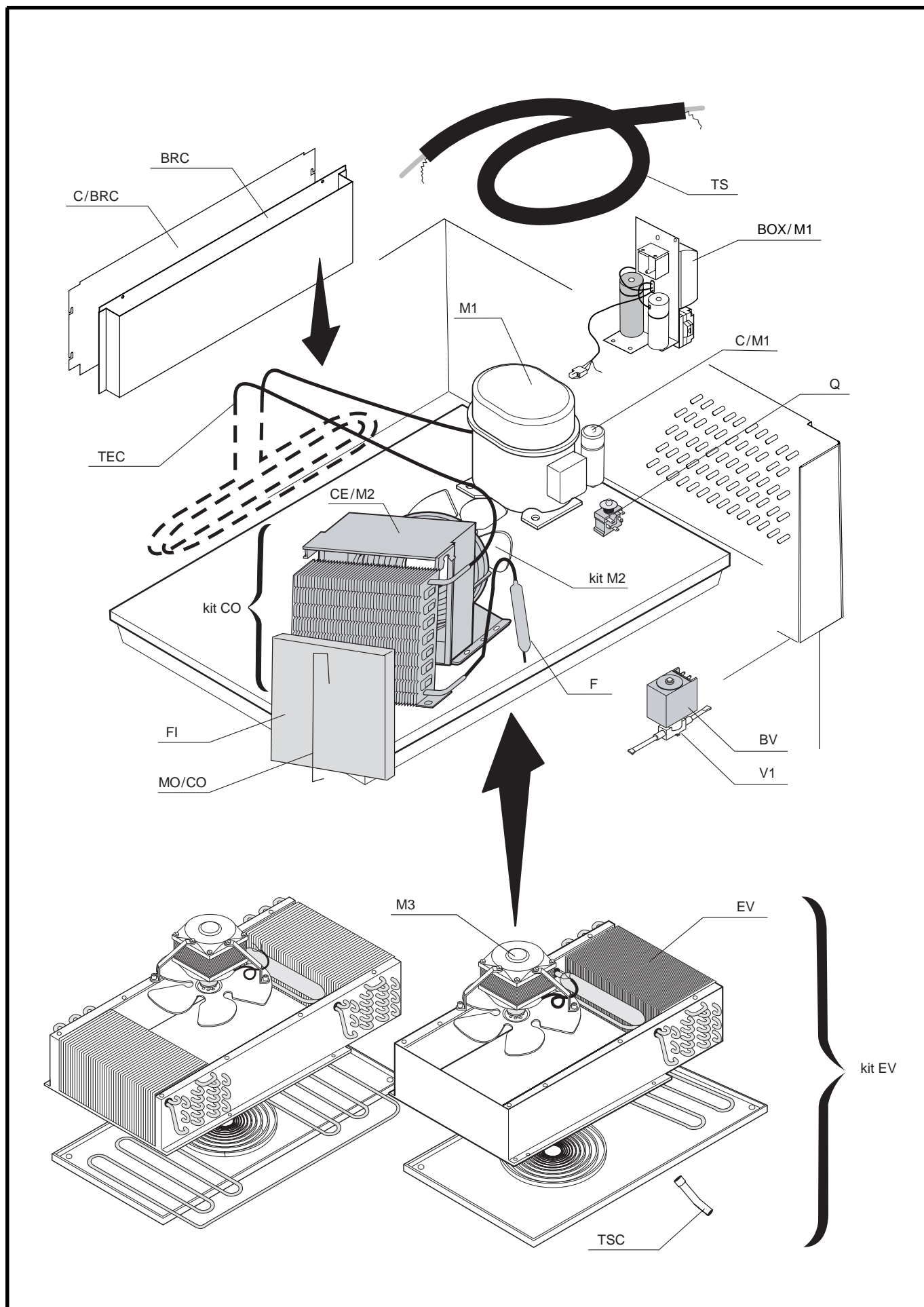

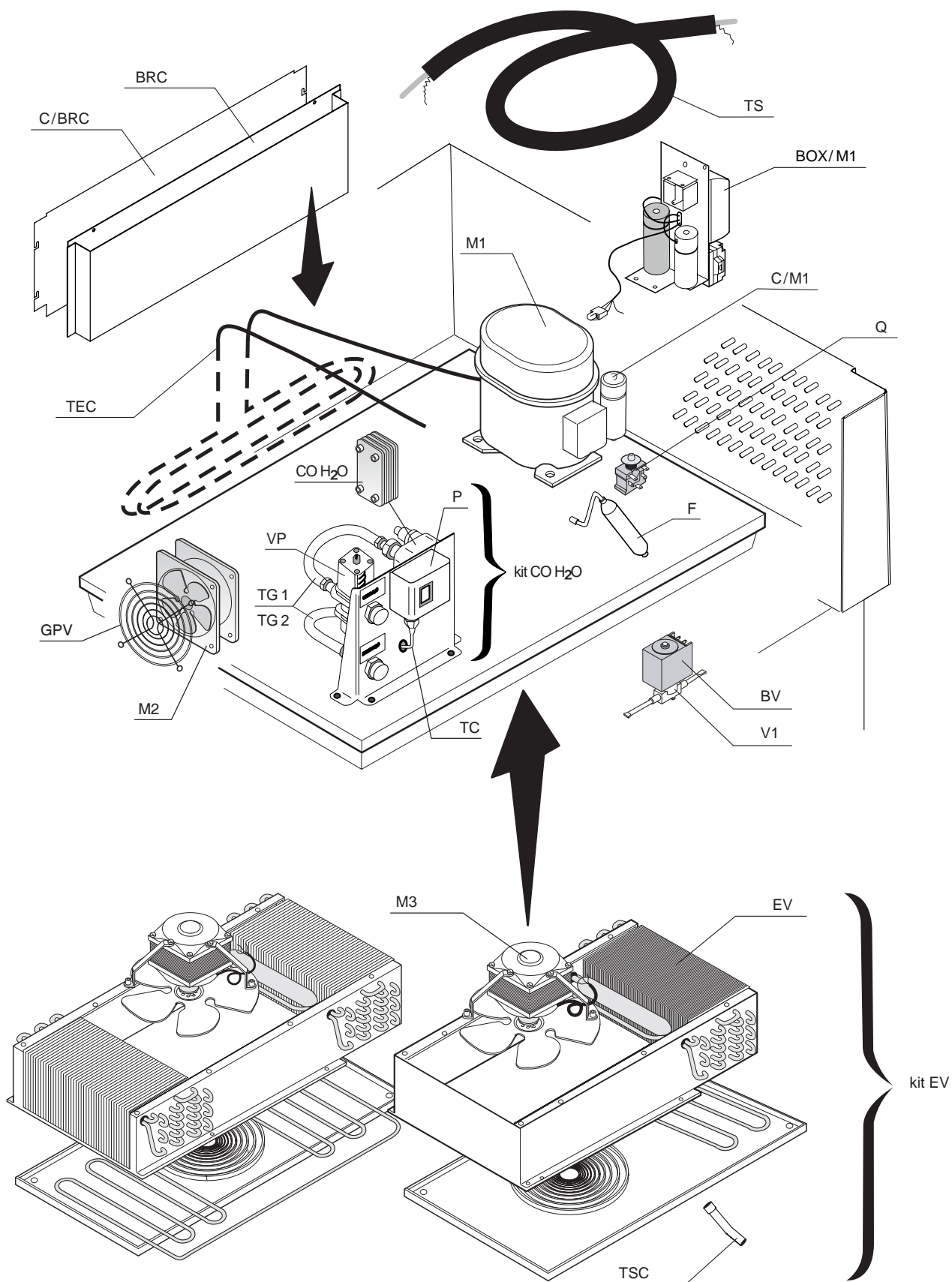

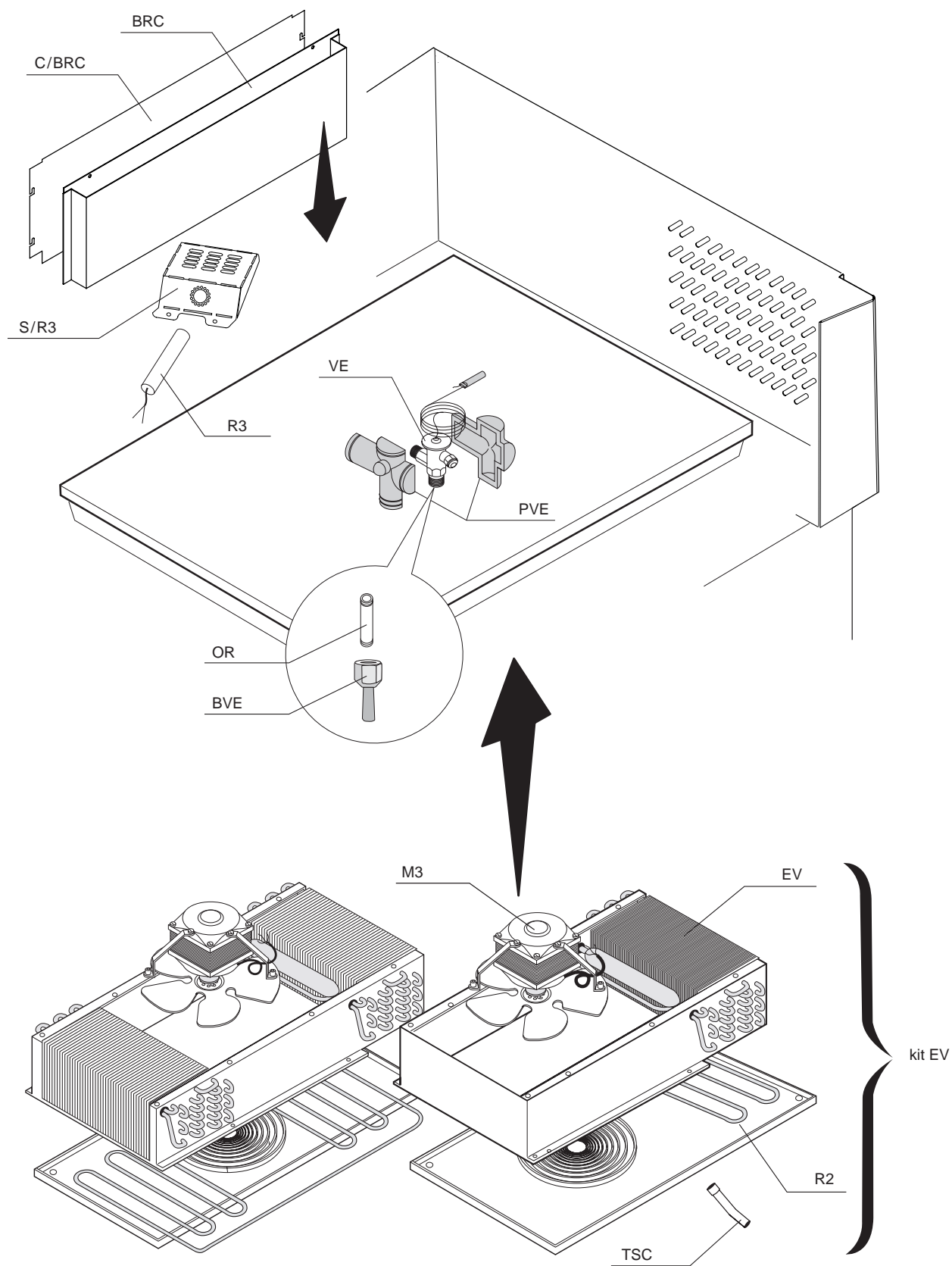

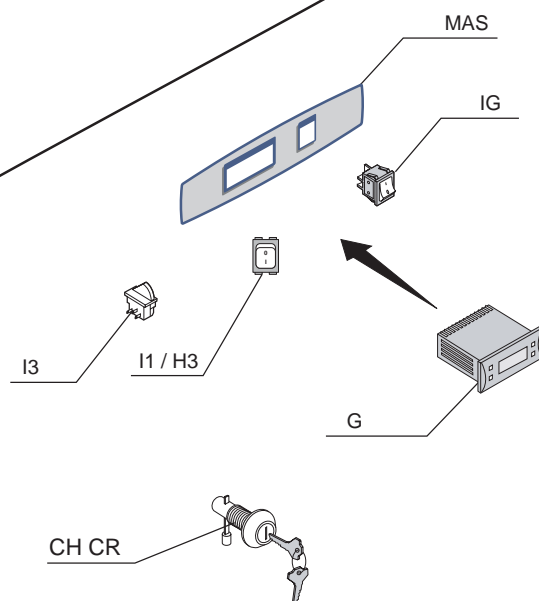
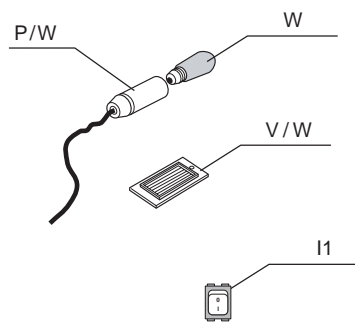
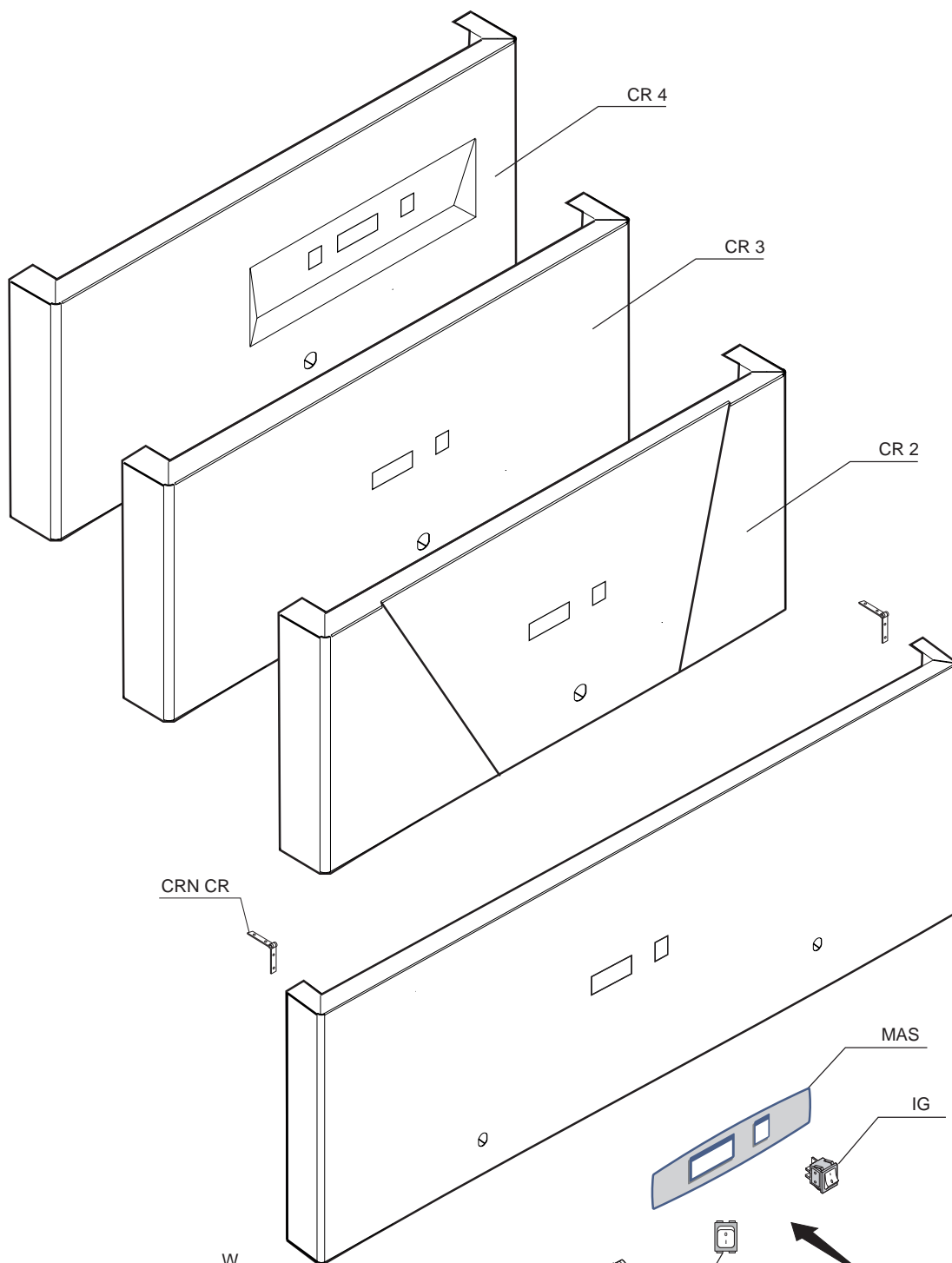

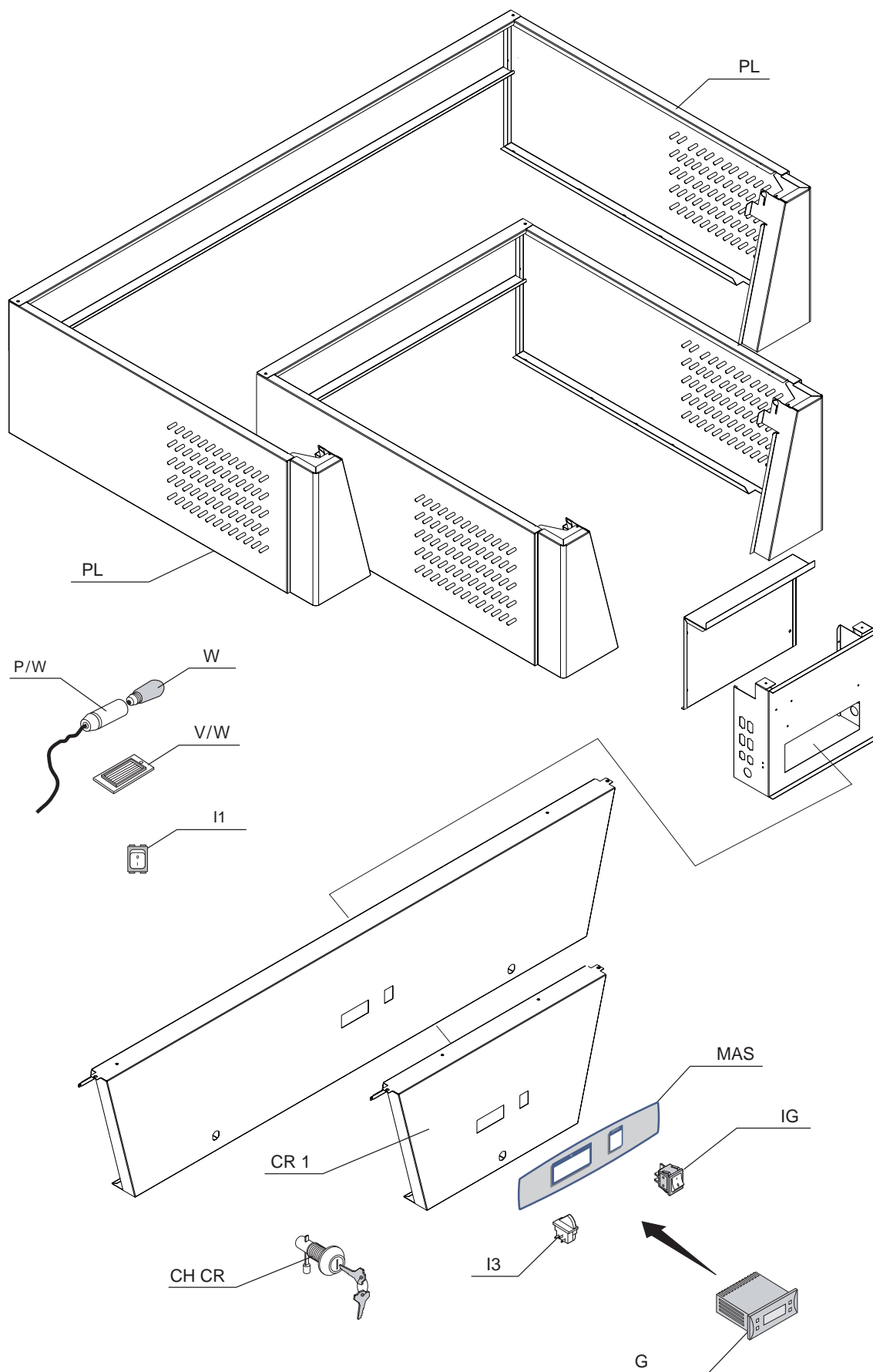

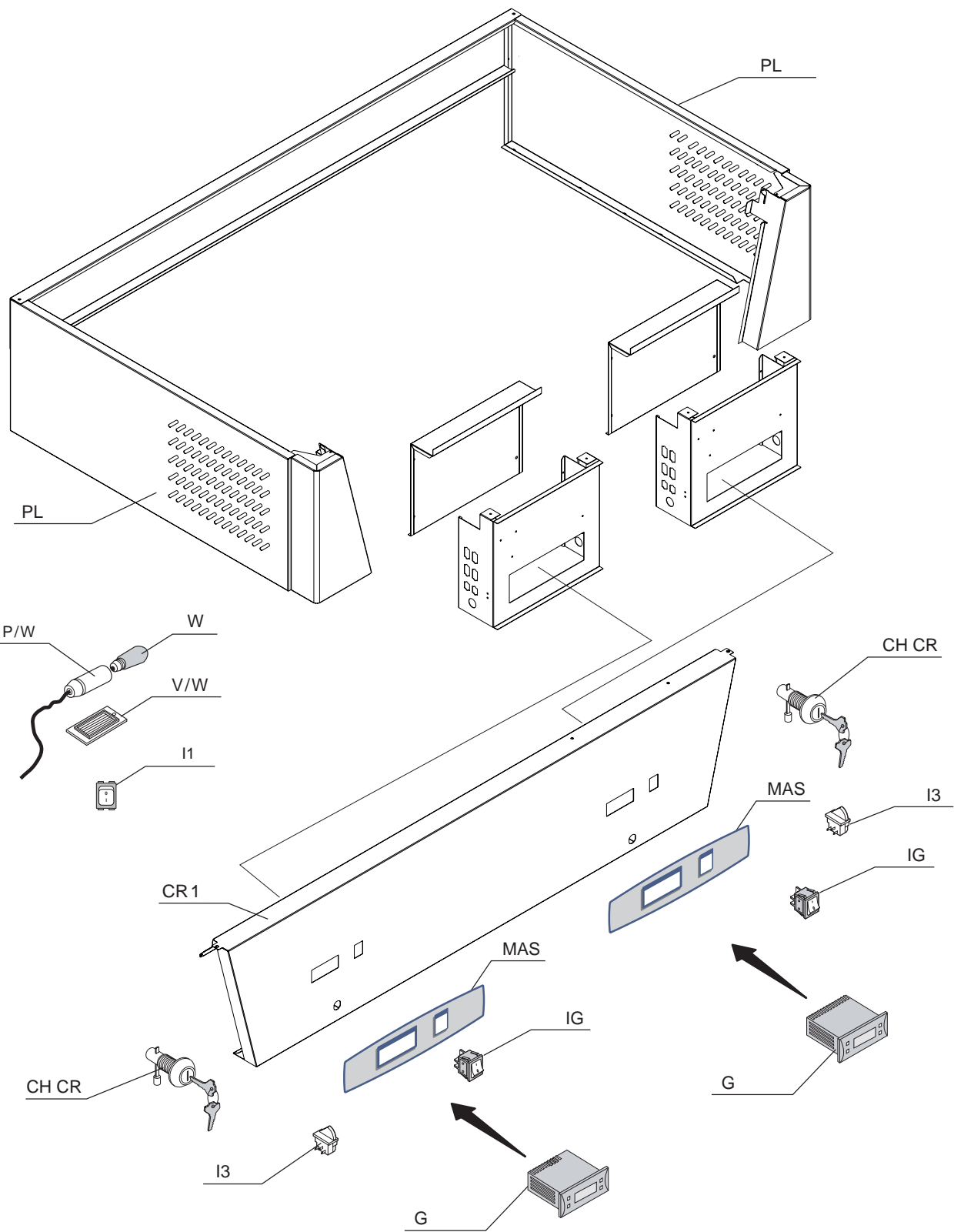

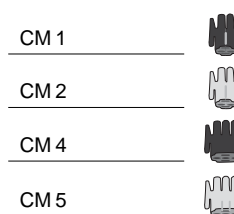
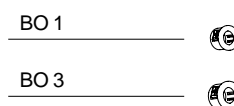
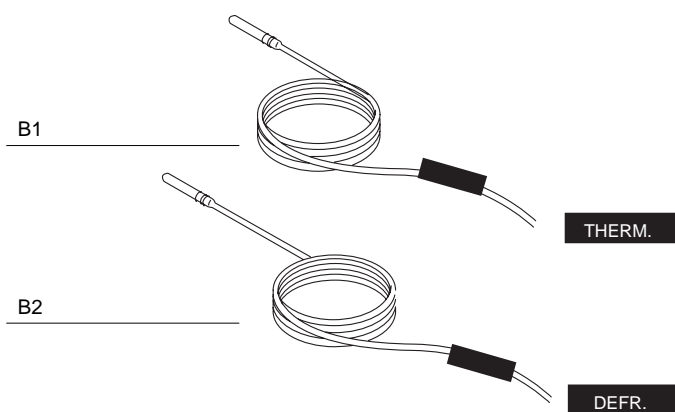
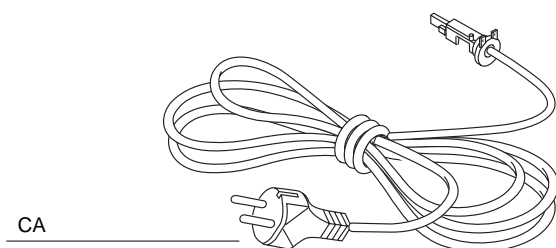
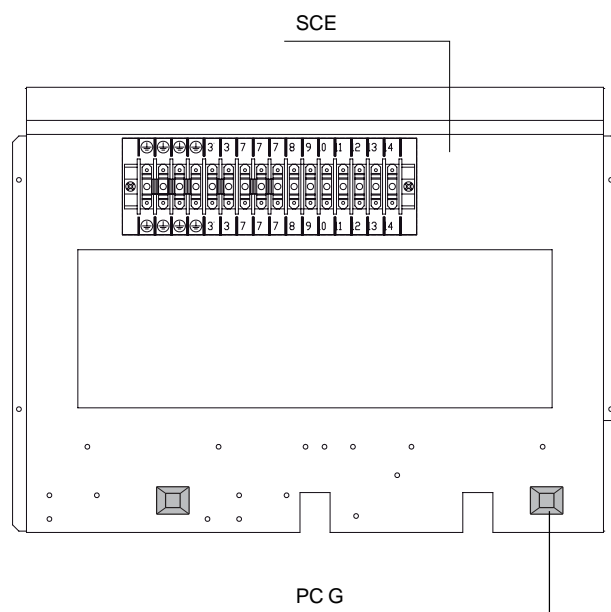

riferim. reference	codice code	descrizione description	modello model	da...a from...to	ricambi cons. rec. spare part
B1 / B2	935886	SONDA NTC CAVOTPE SN691150 L=2,5+TER.F NTC CAVOTPE PROBE SN691150 L=2,5+TER.F	AR_ • ARR_ • AR_VTR • AP_ • ARP_ • AFP_ • AF_ • ARF_ • AF_VTR	22/11/04 00/00/00	●
BA 1	990013	BACINELLA GN1/1 H100 PLASTICA PLASTIC CONTAINER GN1/1 H100	AP7 • ARP142 • AFP142	01/01/95 00/00/00	
BA 2	935470	@@@BACINELLA PLAST.GN2/1 RID.H=100 PLATIC CONTAINER GN2/1 REDUCED H=100	AP6 • ARP122 • AFP122	16/06/97 15/06/97	
	990199	BACINELLA PLAST.GN2/1 RID.H=100 PLATIC CONTAINER GN2/1 REDUCED H=100		16/06/97 00/00/00	
BG O	935341	BN PROFILO CORNICE SCOCCA L=645 S 70 BN PROFILE SUPP. STRUCTURE L. 645 S 70	AR_ • ARR_ • AR_VTR • AP_ • ARP_ • AFP_ • AF_ • ARF_ • AF_VTR	26/09/03 29/07/07	
	936668	AB07 PROFILO AR BATT.GUA.ORIZZ.L=641 AB07 HORIZ.PROFILE FOR DOOR RABBET L=641		30/07/07 00/00/00	
BG T	936670	AB07 PROFILO COP.BATT.GUA.TRAV.L=579 AB07 PROFILE COVERING CROSSBEAM L=579	AR_ • ARR_ • AP_ • ARP_ • AFP_ • AF_ • ARF_	30/07/07 00/00/00	
BG V	935342	BN PROFILO CORNICE SCOCCA L=1606 S 70 BN PROFILE SUPP. STRUCTURE L. 1606 S 70	AR_ • ARR_ • AR_VTR • AP_ • ARP_ • AFP_ • AF_ • ARF_ • AF_VTR	26/09/03 29/07/07	
	936669	AB07 PROFILO AR BATT.GUA.VERT.L=1602 AB07 VERT. PROFILE FOR DOOR RABBET L=1602		30/07/07 00/00/00	
BO 2	996534	BOCCOLA PASSACAVO D=12 BUSH D=12	AR_ • ARR_ • AR_VTR • AP_ • ARP_ • AFP_ • AF_ • ARF_ • AF_VTR	_/_/_ 00/00/00	
BO 3	936038	BOCCOLA PASSACAVO D=14 BUSH D=14	AR_ • ARR_ • AR_VTR • AP_ • ARP_ • AFP_ • AF_ • ARF_ • AF_VTR	_/_/_ 00/00/00	
BO/PO	935976	BOCCOLA PORTA VETRO STAR-EN-PLANET GLASS DOOR BUSH STAR-EN-PLANET	AR_VTR • AF_VTR	20/07/07 00/00/00	
BOX/M1	996025	BOX ELETTRICO DANFOSS '117-7012' ELECTRIC BOX DANFOSS '117-7012'	995770 • 995746	22/05/00 00/00/00	
BRC	996753	BACINELLA DI COPERTURA MONO. SPA 70 COVERING BASIN MONO. SPA 70	AR7 • AR7VTR • AP7 • AF7 • AF7VTR	_/_/_ 00/00/00	
	996754	BACINELLA DI COPERTURA MONO. SPA 140 COVERING BASIN MONO. SPA 140	AR14 • AR14VTR • AP14 • AF14 • AF14VTR	_/_/_ 00/00/00	
BV	996182	BOBINA HM2 230V 50/60HZ X VALVOLA SOLE COIL HM2 230V 50/60HZ FOR SOLENOID VALVE	AF12-14VTR	22/02/05 00/00/00	
BVE	996539	ADATTATORE VALV.ODF 6MM 68-2063 DANFOSS VALVE ADAPTER.ODF 6MM 68-2063 DANFOSS	AR_-P • ARR_-P • AR_VTR-P • AP_-P • ARP_-P • AFP_-P • AF_-P • ARF_-P • AF_VTR-P	28/05/07 00/00/00	
C/BRC	936676	COPERT. BACINELLA AUTOEVAPORANTE ARCO COVERING BACIN GATHER COND. ARCO	AR_ • ARR_ • AR_VTR • AP_ • ARP_ • AFP_ • AF_ • ARF_ • AF_VTR	_/_/_ 00/00/00	
C/M1	996023	CONDENSATORE EL. DANFOSS '117U5015' ELECTRIC CONDENSER DANFOSS '117U5015'	995740 • 996353	22/05/00 13/05/07	
C/M1	996024	CONDENSATORE EL. DANFOSS '117U5017' ELECTRIC CONDENSER DANFOSS '117U5017'	> 996725	22/05/00 00/00/00	
C/M1	996024	CONDENSATORE EL. DANFOSS '117U5017' ELECTRIC CONDENSER DANFOSS '117U5017'	> 995743	22/05/00 12/03/06	
	996550	CONDENSATORE EL. DANFOSS '117U5018' ELECTRIC CONDENSER DANFOSS '117U5018'	> 996540	13/03/06 00/00/00	
C/M1	996764	CONDENSATORE EL. ACC '71982568' ELECTRIC CONDENSER ACC '71982568'	> 996592	14/05/07 00/00/00	
C/M1	996749	CONDENSATORE EL.DANFOSS '117U5012' ELECTRIC CONDENSER DANFOSS '117U5012'	> 996724	11/06/08 00/00/00	
CA	995420	CAVO ALIMENTAZIONE AR-TR SCHUCO ELECTRIC SUPPLY CABLE AR-TR SCHUCO	AR_ • ARR_ • AR_VTR • AP_ • ARP_ • AFP_ • AF_ • ARF_ • AF_VTR	29/05/03 00/00/00	
CE/M2	995775	CONVOGLIATORE CONDENS. STVF 93/139 CONDENSER CONVEYOR STVF 93/139	AR_ • ARR_ • AR_VTR • AP_ • ARP_ • AF6-7 • AF6-7VTR • AFP_ • ARF_	04/03/97 00/00/00	
CE/M2	995759	CONVOGLIATORE CONDENS. STVF 124/194 CONDENSER CONVEYOR STVF 124/194	AF12-14 • AF12-14VTR	08/04/03 00/00/00	
CH CR	935400	SERRATURA A CHIAVE X AR MNSC/22 LOCKING DOOR KEY FOR MNSC/22 CABINETS	AR_ • ARR_ • AR_VTR • AP_ • ARP_ • AFP_ • AF_ • ARF_ • AF_VTR	01/01/95 00/00/00	
CH	925337	COPPIA CHIAVI PORTA TR GOLD 'INOX' PAIR OF KEYS FOR RC DOOR GOLD 'INOX'	AR_ • ARR_ • AP_ • ARP_ • AFP_ • AF_ • ARF_	02/05/06 00/00/00	
CH S	925807	SERRATURA A PALETTO + PERNO TR H=650 N SHAFT-TYPE LOCKING DOOR + PIN RC H=650 N	AR_ • ARR_ • AP_ • ARP_ • AFP_ • AF_ • ARF_	20/09/04 00/00/00	
CM1	936038	CONNETTORE MTL MASC. 2 POLI NERO EDGE CONNECTOR MTL 2 POLES BLACK	AR_ • ARR_ • AR_VTR • AP_ • ARP_ • AFP_ • AF_ • ARF_ • AF_VTR	23/06/04 00/00/00	

riferim. reference	codice code	descrizione description	modello model	da...a from...to	ricambi cons. rec. spare part
CM2	936037	CONNETTORE MTL MASC. 2 POLI BIANCO EDGE CONNECTOR MTL 2 POLES WHITE	AR_ • ARR_ • AR_VTR • AP_ • ARP_ • AFP_ • AF_ • ARF_ • AF_VTR	19/06/03 00/00/00	
CM4	936040	CONNETTORE MTL MASC. 3 POLI NERO EDGE CONNECTOR MTL 3 POLES BLACK	AR_ • ARR_ • AR_VTR • AP_ • ARP_ • AFP_ • AF_ • ARF_ • AF_VTR	29/11/04 00/00/00	
CM5	936036	CONNETTORE MTL MASC. 3 POLI BIANCO EDGE CONNECTOR MTL 3 POLES WHITE	AR_ • ARR_ • AR_VTR • AP_ • ARP_ • AFP_ • AF_ • ARF_ • AF_VTR	29/11/04 00/00/00	
CN	935319	CANOTTO INOX AR MNSCOCCA PORTEVETRO INOX TUBE FOR MNCQ CAB. GLASS DOORS	AR_V • AF_V	21/03/06 00/00/00	
CO H2O	995909	CONDENSATORE H2O SALDOBR. ZC207 10 PIA WATER CONDENSER BRAZED ZC207 10 PLATES		17/11/05 00/00/00	
CR 1	6157500	***ASS. CRUSCOTTO AR7 ECONOMICO FRONTAL PANEL AR7 ECONOMIC	AR6-7 • AR6-7VTR • AP6-7 • AF6-7 • AF6-7VTR	18/04/05 31/08/05	
	935945	ASS. CRUSCOTTO AR7 1T ECO NEW FRONTAL PANEL AR7 1T ECO NEW		01/09/05 00/00/00	
CR 1	6157510	***ASS. CRUSCOTTO AR14 ECONOMICO FRONTAL PANEL AR14 ECONOMIC	AR12-14 • AR12-14VTR • AP12-14 • AF12- 14 • AF12-14VTR	18/04/05 31/08/05	
	935946	ASS. CRUSCOTTO AR14 1T ECO NEW FRONTAL PANEL AR14 1T ECO NEW		14/02/06 00/00/00	
CR 2	935824	ASS.CRUSCOTTO AR PLANET 700 FRONTAL PANEL RC PLANET 700	AR6-7 • AR6-7VTR • AP6-7 • AF6-7 • AF6-7VTR	25/05/04 17/04/05	
	935904	ASS.CRUSCOTTO AR PLANET 700 FRONTAL PANEL RC PLANET 700		18/04/05 31/08/05	
	935932	ASS.CRUSCOT.AR/AF7 PLANET FRONTAL PANEL AR7 1T ECO NEW		27/09/05 00/00/00	
CR 2	935932	ASS.CRUSCOT.AR/AF7 PLANET FRONTAL PANEL AR7 1T ECO NEW	AR7 • AR7VTR • AP7 • AF7 • AF7VTR	27/09/05 31/08/08	
	935932	CRUS. SPA/PLANET 70-SERR.TERM. ID FR. PANEL SPA/PLANET 70-LOCK THERM. ID		01/09/08 00/00/00	
CR 2	935825	ASS.CRUSCOTTO AR PLANET 1400 FRONTAL PANEL FOR PLANET 1400 CABINET	AR12-14 • AR12-14VTR • AP12-14 • AF12- 14 • AF12-14VTR	12/11/04 17/04/05	
	935905	ASS.CRUSCOTTO AR PLANET 1400 FRONTAL PANEL RC PLANET 1400		19/04/05 31/08/05	
	935933	ASS. CRUSCOTTO AR14 PLANET NEW FRONTAL PANEL AR14 PLANET NEW		27/09/05 00/00/00	
CR 2	935933	ASS. CRUSCOTTO AR14 PLANET NEW FRONTAL PANEL AR14 PLANET NEW	AR14 • AR14VTR • AP14 • AF14 • AF14VTR	27/09/05 31/08/08	
	935115	CRUSC. SPA/PLANET140 SERRATURA TERM.ID FR. PANEL SPA/PLANET140 LOCK THERM. ID		01/09/08 00/00/00	
CR 2	935826	ASS.CRUSCOTTO AR PLANET 1400 2TEMP. FRONTAL PANEL PLANET CAB. 1400 2TEMP.	ARR_ • ARP_ • AFP_ • ARF_	15/12/04 17/04/05	
	935906	ASS.CRUSCOTTO AR PLANET 1400 2T FRONTAL PANEL RC PLANET 1400 2T		18/04/05 31/08/05	
	936667	ASS. CRUSCOTTO AR14 2T PLANET NEW FRONTAL PANEL RC14 2TEMP. PLANET NEW		01/09/05 00/00/00	
CR2	996756	ASS.CRUSCOTTO AR7 PLANET KBS FRONTAL PANELAR7 PLANET KBS	AR6-7 • AR6-7VTR • AP6-7 • AF6-7 • AF6-7VTR	_/_/_ 00/00/00	
CR2	935116	CRUSCOTTO SPA/PLANET 140 CON SERRAT. FR. PANEL SPA/PLANET 140 WITH LOCK	AR12-14 • AR12-14VTR • AP12-14 • AF12- 14 • AF12-14VTR	_/_/_ 00/00/00	
CR 3	935943	ASS. CRUSCOTTO PIANO AR7 1T NEW FRONTAL PANEL FLAT AR7 1T NEW	AR6-7 • AR6-7VTR • AP6-7 • AF6-7 • AF6-7VTR	14/02/06 00/00/00	
CR 3	935944	ASS. CRUSCOTTO PIANO AR14 1T NEW FRONTAL PANEL FLAT AR14 1T NEW	AR12-14 • AR12-14VTR • AP12-14 • AF12- 14 • AF12-14VTR	14/02/06 00/00/00	
CR 3	936666	ASS. CRUSCOTTO PIANO AR14 2T NEW FRONTAL PANEL FLAT AR14 2T NEW	ARR_ • ARP_ • AFP_ • ARF_	01/09/05 00/00/00	
CRN dx	936664	KIT CERNIERA INFER. DX AR MONOSCOCCA LOWER RIGHT HINGE KIT MONOCOQUE CABINETS	AR_ • ARR_ • AP_ • ARP_ • AFP_ • AF_ • ARF_	_/_/_ 00/00/00	
CRN sx	936665	KIT CERNIERA INFER. SX AR MONOSCOCCA LOWER LEFT HINGE KIT MONOCOQUE CABINETS	AR_ • ARR_ • AP_ • ARP_ • AFP_ • AF_ • ARF_	_/_/_ 00/00/00	
CRN ½ dx	935835	ASS.SUPP.CERN.PO.1/2 DX AR PLANET RIGHT HINGE ASS. FOR HALF DOOR PLANET CAB.	AR_ • ARR_ • AP_ • ARP_ • AFP_ • AF_ • ARF_	15/11/04 00/00/00	
CRN ½ sx	935836	ASS.SUPP.CERN.PO.1/2 SX AR PLANET LEFT HINGE ASS. FOR HALF DOOR PLANET CAB.	AR_ • ARR_ • AP_ • ARP_ • AFP_ • AF_ • ARF_	15/11/04 00/00/00	
CRN 1 dx	935713	ASS.CERNIERA INFER.DX AR MONOSCOCCA LOWER RIGHT HINGE ASS. MNSC CABINETS	AR_ • ARR_ • AP_ • ARP_ • AFP_ • AF_ • ARF_	19/09/03 00/00/00	

riferim. reference	codice code	descrizione description	modello model	da...a from...to	ricambi cons. rec. spare part
CRN 1 sx	935712	ASS.CERNIERA INFER.SX AR MONOSCOCCA LOWER LEFT HINGE ASS. MNSC CABINETS	AR_ • ARR_ • AP_ • ARP_ • AFP_ • AF_ • ARF_	29/11/07 00/00/00	
CRN 1V dx	935975	CERNIERA INF.DX AR VTR STAR/PLANET/EN LOWER RIGHT HINGE GL.DOOR STAR/PLANET/EN	AR_VTR • AF_VTR	29/11/07 00/00/00	
CRN 1V sx	935981	CERNIERA INF.SX AR VTR STAR/PLANET/EN LOWER LEFT HINGE GL.DOOR STAR/PLANET/EN	AR_VTR • AF_VTR	29/11/07 00/00/00	
CRN 2 dx	935715	PIASTRA FERMO PORTA 'DX'PV'AR MNSC RIGHT LOCKING DOOR PLATE 'PV'AR MNSC	AR_ • ARR_ • AR_VTR • AP_ • ARP_ • AFP_ • AF_ • ARF_ • AF_VTR	19/09/03 00/00/00	
CRN 2 sx	935714	PIASTRA FERMO PORTA 'SX'PV'AR MNSC LEFT LOCKING DOOR PLATE 'PV'AR MNSC	AR_ • ARR_ • AR_VTR • AP_ • ARP_ • AFP_ • AF_ • ARF_ • AF_VTR	19/09/03 00/00/00	
CRN 3 dx	935696	MOLLA PORTA DX ARMADI CANOTTO IN ABS RIGHT SPRING FOR DOOR CABINETS	AR_ • ARR_ • AR_VTR • AP_ • ARP_ • AFP_ • AF_ • ARF_ • AF_VTR	15/04/03 00/00/00	
CRN 3 sx	935697	MOLLA PORTA SX ARMADI CANOTTO IN ABS LEFT SPRING FOR DOOR CABINETS	AR_ • ARR_ • AR_VTR • AP_ • ARP_ • AFP_ • AF_ • ARF_ • AF_VTR	15/04/03 00/00/00	
CRN 4	935982	PIASTRINA PER CERN.P 1/2 AR PLANET HINGE PLATE FOR HALF DOOR PLANET CAB.	AR_ • ARR_ • AR_VTR • AP_ • ARP_ • AFP_ • AF_ • ARF_ • AF_VTR	27/04/05 00/00/00	
CRN 5	935983	FALSA CERNIERA AR PLANET HINGE PLANET CABINETS	AR_ • ARR_ • AR_VTR • AP_ • ARP_ • AFP_ • AF_ • ARF_ • AF_VTR	27/06/06 00/00/00	
CRN 6	936677	SPESSORE CERNIERA VTR PLANET NEW HINGE SHIM FOR GLASS DOOR PLANET NEW	AR_VTR • AF_VTR	06/05/06 00/00/00	
CRN CR	936041	CERNIERA BISCOTTO ACC.ZN .MM 15X100 HINGE FOR FR. PANEL GALV. STEEL .MM 15X100	AR_ • ARR_ • AR_VTR • AP_ • ARP_ • AFP_ • AF_ • ARF_ • AF_VTR	_/_/_ 00/00/00	
CRNI 1/2 dx	996349	ASS.CERN.INF.DX P1/2 1DX+1SX STAR/PLAN LOWER RIGHT HINGE ASS. 1R+1L DOOR ST/PL	AR_ • ARR_ • AP_ • ARP_ • AFP_ • AF_ • ARF_	19/01/06 00/00/00	
CRNI 1/2 sx	996344	ASS.CERN.INF.SX P1/2 1DX+1SX STAR/PLAN LOWER LEFT HINGE ASS. 1R+1L DOOR ST/PL	AR_ • ARR_ • AP_ • ARP_ • AFP_ • AF_ • ARF_	20/12/05 00/00/00	
CRNS 1/2 dx	996345	ASS.CERN.SUP.DX P1/2 1DX+1SX STAR/PLAN UPPER RIGHT HINGE ASS. 1R+1L DOOR ST/PL	AR_ • ARR_ • AP_ • ARP_ • AFP_ • AF_ • ARF_	20/12/05 00/00/00	
CRNS 1/2 sx	996348	ASS.CERN.SUP.SX P1/2 1DX+1SX STAR/PLAN UPPER LEFT HINGE ASS. 1R+1L DOOR ST/PL	AR_ • ARR_ • AP_ • ARP_ • AFP_ • AF_ • ARF_	19/01/06 00/00/00	
CRNS 1V	935837	ASS.CERN.SUPER.DX/SX AR VTR PLANET UPPER RIGHT/LEFT HINGE PLANET CAB.GLASSES	AR_VTR • AF_VTR	26/10/04 31/08/05	
	935921	ASS.CERN.SUPER.DX/SX AR VTR PLANET NEW UPPER RIGHT/LEFT HINGE GL.DOOR PLANET NEW		30/06/06 00/00/00	
CRNS 2	935832	ASS.CERN.SUP.DX/SX ARMADI PLANET UPPER RIGHT/LEFT HINGE PLANET CABINETS	AR_ • ARR_ • AP_ • ARP_ • AFP_ • AF_ • ARF_	19/10/04 19/09/05	
CRNS dx	935922	ASS.CERN.SUP.DX ARMADI PLANET NEW UPPER RIGHT HINGE ASS. PLANET CAB. NEW	AR_ • ARR_ • AP_ • ARP_ • AFP_ • AF_ • ARF_	31/08/05 12/03/07	
	935963	ASS.CERN.SUP.DX AR PLANET NEW NEW UPPER RIGHT HINGE ASS. PLANET CAB. NEW		13/03/07 00/00/00	
CRNS sx	935923	ASS.CERN.SUP.DX ARMADI PLANET NEW UPPER RIGHT HINGE ASS. PLANET CAB. NEW	AR_ • ARR_ • AP_ • ARP_ • AFP_ • AF_ • ARF_	31/08/05 12/03/07	
	935964	ASS.CERN.SUP.DX AR PLANET NEW NEW UPPER RIGHT HINGE ASS. PLANET CAB. NEW		13/03/07 00/00/00	
EV	935869	EVAPORATORE 5R-5T AR6/7 PLANET EVAPORATOR 5 ROWS 5T AR6/7 PLANET	AK6-7 • AKK_ • AK6-7VTR • AP6-7 • ARP_ • AFP_ • AF6-7 • AF6-7VTR • ARF_	16/11/04 00/00/00	
EV	935878	EVAPOR.DOPPIO 4R-5T AR12/14 PLANET EVAPORATOR5 4R-5T AR12/14 PLANET	AR12-14 • AR12-14VTR • AP12-14 • AF12- 14 • AF12-14VTR	17/11/04 00/00/00	
F	995377	FILTRO DISIDRATORE 25 GR 6X3 DEHYDRATOR FILTER 25 GR 6X3	AR_ • ARR_ • AR_VTR • AP_ • ARP_ • AFP_ • AF6-7 • ARF_ • AF6-7VTR	01/01/95 00/00/00	
F	995482	FILTRO DISIDRATORE 40 GR 6X3 DEHYDRATOR FILTER 40 GR 6X3	AF12-14	01/01/95 00/00/00	
F	995690	FILTRO DISIDRATORE ODF DML032S 023Z455 DEHYDRATOR FILTER ODF DML032S 023Z455	AF12-14VTR	21/11/03 00/00/00	
FI	935320	FILTRO CONDENSATORE AR7-14-21 MNSC FILTER CONDENSER AR7-14-21 MNSC	AF12-14 • AF12-14VTR	01/01/95 00/00/00	
FI	935322	FILTRO CONDENSATORE AR6-12 MNSC FILTER CONDENSER AR6-12 MNSC	AR_ • ARR_ • AR_VTR • AP_ • ARP_ • AFP_ • AF6-7 • ARF_ • AF6-7VTR	01/01/95 00/00/00	
FF 1	990010	FALSO FONDO FORATO GN1/1 H 15 INOX FALSE DRILLED BOTTOM GN1/1 H 15 INOX	AP7-14 • ARP142 • AFP142	02/11/06 00/00/00	
FF 2	935471	@@@FALSO FONDO FORATO GN2/1 RIDOTTO FALSE DRILLED BOTTOM GN2/1 REDUCED	AP6-12 • ARP122 • AFP122	12/02/98 15/06/97	
	990200	FALSO FONDO FORATO GN2/1 RIDOTTO FALSE DRILLED BOTTOM GN2/1 REDUCED		16/06/97 00/00/00	

riferim. reference	codice code	descrizione description	modello model	da...a from...to	ricambi cons. rec. spare part
G	996198	TELETERMOSTATO ID974 AR PLANET TELETERMOSTAT ID974 AR PLANET	AR_ • ARR_ • AR_VTR • AP_ • ARP_ • AFP_ • ARF_	14/03/03 00/00/00	●
G	996199	TELETERMOSTATO ID974 AF PLANET TELETERMOSTAT ID974 AF PLANET	AFP_ • AF_ • ARF_ • AF_VTR	14/03/03 00/00/00	●
G	996659	TELET.DIXELL XW60L TN PRIMUS/PLANECO TELETH. DIXELL XW60L TN PRIMUS/PLANECO	AR_ • ARR_ • AR_VTR • AP_ • ARP_ • AFP_ • ARF_	25/01/08 00/00/00	●
G	996768	TELET.DIXELL XW60L BT PRIMUS/PLANECO TELETH. DIXELL XW60L BT PRIMUS/PLANECO	AFP_ • AF_ • ARF_ • AF_VTR	25/01/08 00/00/00	●
G	996730	TELET. DIXELL XW20L -5N0C1 0/+10 PRIMUS TELETH. DIXELL XW20L -5N0C1 0/+10 PRIMUS	AR_ • ARR_ • AR_VTR • AP_ • ARP_ • AFP_ • ARF_	24/06/08 00/00/00	●
GC 1	935795	COPPIA GUIDE A "C" GN2/1 L=615 PAIR OF "C" SLIDES GN2/1 L=615	AR7-14 • ARR142 • AR7-14VTR • AP7-14 • ARP142 • AFP142 • AF7-14 • ARF142 • AF7-14VTR	24/06/04 00/00/00	
GC 2	935847	COPPIA GUIDE A "C" GN2/1RID. AR PLANET PAIR OF "C" SLIDES GN2/1 RID. PLANET CAB.	AR6-12 • ARR122 • AR6-12VTR • AP6-12 • ARP122 • AFP122 • AF6-12 • ARF122 • AF6-12VTR	15/11/04 00/00/00	
GPO	935813	GUARNIZ P.INT.AR PLANET DOOR GASKET PLANET CABINET	AR_ • ARR_ • AP_ • ARP_ • AFP_ • AF_ • ARF_	05/12/03 00/00/00	●
GPO 1/2	935850	RES.BAT.GUARN.P.1/2 41W PLANET/STAR HALF DOOR GASKET 41W PLANET/STAR	AR_ • ARR_ • AP_ • ARP_ • AFP_ • AF_ • ARF_	15/11/04 16/05/07	●
	935812	GUARNIZ P.1/2 AR PLANET HALF DOOR GASKET PLANET CABINET		17/05/07 00/00/00	●
GPO V	935844	GUARNIZ.PORTA VETRO AR PLANET GLASS DOOR GASKET PLANET CABINET	AR_VTR • AF_VTR	15/11/04 00/00/00	●
GR 1	990025	GRIGLIA GN2/1 PLASTIFICATA PLASTICIZED SHELF GN2/1	AR7-14 • ARR142 • AR7-14VTR • AF7-14 • ARF7-14 • AF7-14VTR	08/09/98 20/11/03	
	990230	GRIGLIA GN2/1 PLASTIFICATA PLASTICIZED SHELF GN2/1		21/11/03 00/00/00	
GR 2	990037	GRIGLIA 550X530 GN2/1R PLASTIF.CON MAN PLAST. SHELF 550X530 GN2/1R WITH HANDLE	AR6-12 • ARR122_ • AR6-12VTR • AF6-12 • ARF122 • AF6-12VTR	09/02/04 00/00/00	
GS	935806	ASS.MONT.SX ANT/POST.AR6/7 PLANET LEFT FRONT/BACK UPRIGHTS AR6/7 PLANET	AR_ • ARR_ • AR_VTR • AP_ • ARP_ • AFP_ • AF_ • ARF_ • AF_VTR	10/11/04 00/00/00	
GS	935807	ASS.MONT.DX ANT/POST.AR6/7 PLANET RIGHT FRONT/BACK UPRIGHTS AR6/7 PLANET	AR_ • ARR_ • AR_VTR • AP_ • ARP_ • AFP_ • AF_ • ARF_ • AF_VTR	10/11/04 00/00/00	
GS ½	935851	MONT.MZ DX ANT/POST AR PLANET RIGHT FRONT/BACK UPRIGHT PLANET CABINETS	AR_ • ARR_ • AP_ • ARP_ • AFP_ • AF_ • ARF_	15/11/04 00/00/00	
GS ½	935852	MONT.MZ SX ANT/POST AR PLANET LEFT FRONT/BACK UPRIGHT PLANET CABINETS	AR_ • ARR_ • AP_ • ARP_ • AFP_ • AF_ • ARF_	15/11/04 00/00/00	
GS C	935856	MONT.CENTRALE POST. AR 14 PLANET CENTRAL BACK UPRIGHT PLANET CABINETS	AR12-14 • ARR_ • AR12-14VTR • AP12-14 • ARP_ • AFP_ • AF12-14 • ARF_ • AF12-14VTR	15/11/04 00/00/00	
I1	996032	INTERRUTTORE BIPOLARE LUMINOSO BIANCO BIPOLAR SWITCH WHITE LIGHT	AR_VTR • AF_VTR	21/09/04 00/00/00	●
I3	935823	MICROPORTA DEVIATORE LUCE+VENT.AR PL. MICRO-SWITCH LIGHT+FAN PLANET CABINET	AR_ • ARR_ • AR_VTR • AP_ • ARP_ • AFP_ • AF_ • ARF_ • AF_VTR	12/11/04 00/00/00	●
IG	995257	INTERRUTTORE GENERALE VERDE C/GRIGIA MAIN SWITCH GREEN C/GRAY	AR_ • ARR_ • AR_VTR • AP_ • ARP_ • AFP_ • AF_ • ARF_ • AF_VTR	28/05/03 00/00/00	●
kit CRN IP½	930225	KIT INV.1/2 PORTE.DA DX A SX AR PLANET INV. KIT FROM RIGHT-LEFT FOR 1/2 DOOR P.C.	AR_ • ARR_ • AP_ • ARP_ • AFP_ • AF_ • ARF_	02/04/08 00/00/00	
kit CRN IPO	930266	KIT INV.PORTA DA DX A SX AR PLANET NEW KIT INV. DOOR FROM RIGHT TO LEFT CAB. NEW	AR_ • ARR_ • AP_ • ARP_ • AFP_ • AF_ • ARF_	19/09/03 00/00/00	
kit CRN IPO	930298	KIT INV.PORTA DA SX A DX AR PLANET NEW KIT INV. DOOR FROM LEFT TO RIGHT CAB. NEW	AR_ • ARR_ • AP_ • ARP_ • AFP_ • AF_ • ARF_	30/09/09 00/00/00	
kit CRN IPV	930227	KIT INV.PORTA DA DX A SX AR VTR PLANET INV. KIT FROM RIGHT-LEFT FOR GL. DOOR P.C.	AR_VTR • AF_VTR	27/06/06 00/00/00	
kit CO	995522	CONDENSATORE STVF 139 CONV RINF C/CURV STVF 139 COND. WITH ENFORCED CONVEYOR	AF6-7 • AF6-7VTR • AR12-14 • AR12- 14VTR • AFP_ • ARF_	01/01/95 00/00/00	
kit CO	995523	CONDENSATORE STVF 194 CONV RINF C/CURV STVF 194 CONDENSER WITH ENF. CONVEYOR	AF12-14 • AF12-14VTR	01/01/95 00/00/00	
kit CO	995524	CONDENSATORE STVF 93 CONV RINF C/CURV STVF 93 COND. WITH ENFORCED CONVEYOR	AR6-7 • ARR_ • AR6-7VTR • AP_ • ARP_ • AFP_ • ARF_	01/01/95 00/00/00	
kit CO H2O	935117	KIT CONDENSATORE H2O SALDOBR. AR ZC207 WATER COND. KIT BRAZED CABINETS ZC207		11/11/05 00/00/00	

riferim. reference	codice code	descrizione description	modello model	da...a from...to	ricambi cons. rec. spare part
kit EV	935868	ASS.EVAPORATORE 5R-5T AR6/7 PLANET FAN ASS. 5 ROWS - 5T AR6/7 PLANET	AR6-7 • ARR_ • AR6-7VTR • AP_ • ARP_ • AFP_ • AF6-7 • AF6-7VTR • ARF_	16/11/04 00/00/00	
kit EV	935877	ASS.EVAPOR.DOPPIO 5R-4T AR12/14 PLANET DOUBLE FAN ASS. 5R-4T AR12/14 PLANET	AR12-14 • AR12-14VTR • AF12-14 • AF12-14VTR	16/11/04 00/00/00	
M1	995711	COMPRESSORE 34,37CC J2212GK CSR R404A COMPRESSOR 34,37CC J2212GK CSR R404A	AF12-14VTR	30/07/05 12/09/08	
M1	995746	COMPRESSORE 20,4 CC T2178GK/SC18CL R404A COMPRESSOR 20,4 CC T2178GK/SC18CL R40	AF6-7VTR	30/07/05 12/09/08	
	996724	COMPRESSORE DANFOSS SC 18 CLX.2 R404A COMPRESSOR DANFOSS SC 18 CLX.2 R404A		15/09/08 00/00/00	
M1	995770	COMPRESSORE 22,4 CC.T2180GK-SC21CL R404A COMPRESSOR 22,4 CC.T2180GK-SC21CL R404A	AF12-14	30/04/97 00/00/00	
M1	995740	COMPRESSORE NL7.3MF FR8.5G/B6160Z R134 COMPRESSOR NL7.3MF FR8.5G/B6160Z R134	AR6-7 • ARR_ • AR6-7VTR • AP6-7 • ARP_ • AFP_ • ARF_	21/11/03 05/11/06	
	996353	COMPRESS.DANFOSS NL7.3MF R134A 230/50- COMPRESSOR DANFOSS NL7.3MF R134A 230/50-		06/11/06 13/05/07	
	996592	COMPRESS.ACC GL80TB R134A 220-240/1/50 COMPRESSOR ACC GL80TB R134A 220-240/1/50		14/05/07 00/00/00	
M1	995743	COMPRESSORE 12,00 CC E6187Z/SC12G R134A COMPRESSOR 12,00 CC E6187Z/SC12G R134A	AR12-14 • AP12-14	21/11/03 12/03/06	
	996355	COMPRESS.DANFOSS NL10 MF R134A 230/50- COMPRESSOR DANFOSS NL10 MF R134A 230/50-		13/03/06 00/00/00	
M1	995745	COMPRESSORE 17,4 CC T2168GK/SC15CL R40 COMPRESSOR 17,4 CC T2168GK/SC15CL R40	AF6-7 • AFP_ • ARF_	21/11/03 12/09/08	
	996725	COMPRESSORE DANFOSS SC 15 CLX.2 R404A COMPRESSOR DANFOSS SC 15 CLX.2 R404A		15/09/08 00/00/00	
M2	995635	VENTIL. PIATTO D=120 230V 4715MS-23T-B FLAT FAN D=120 230V 4715MS-23T-B		17/11/05 00/00/00	●
kit M2	995526	MOTORE+VENTOLA COND. STVF 124/194 ENGINE + CONDENSER FAN STVF 124/194	AF12-14 • AF12-14VTR	09/06/97 00/00/00	●
kit M2	996158	MOTORE+VENTOLA COND. STVF 93 ENGINE + CONDENSER FAN STVF 93	AR_ • ARR_ • AR_VTR • AP6-7 • AP12-14 • ARP_ • AFP_ • ARF_	02/10/02 00/00/00	●
M3	935870	VENT.ELCO 50/60 38-10W 1500G D=200 28° ELCO FAN 50/60 38-10W 1500G D=200 28°	AR6-7 • ARR_ • AR6-7VTR • AP6-7 • ARP_ • AFP_ • AF6-7 • AF6-7VTR • ARF_	16/11/04 00/00/00	●
M3	935873	VENT.ELCO 50/60 53-10W 1500G D=230 28° ELCO FAN 50/60 53-10W 1500G D=230 28°	AR12-14 • AR12-14VTR • AP12-14 • AF12-14 • AF12-14VTR	16/11/04 00/00/00	●
MAS	935822	MASCHERINA COMANDI AR PLANET FRIULINOX CONTROL PANEL RC PLANET FRIULINOX	AR_ • ARR_ • AR_VTR • AP_ • ARP_ • AFP_ • AF_ • ARF_ • AF_VTR	28/04/04 00/00/00	
MO/CO	935959	MOLLA FISSAGGIO FILTRO STVF L=280 FIXING SPRING FOR CONDENSER FILTER L=280	AR_ • ARR_ • AR_VTR • AP_ • ARP_ • AFP_ • AF_ • ARF_ • AF_VTR	29/11/04 00/00/00	
MN	935846	MANIGLIA PORTA VTR AR PLANET HANDLE FOR GLASS DOOR PLANET CABINETS	AR_VTR • AF_VTR	07/03/05 00/00/00	
OR	996208	ORIFIZIO N°00 DANFOSS N.00 ORIFICE DANFOSS	AR_-P • ARR_-P • AR_VTR-P • AP_-P • ARP_-P • AFP_-P • ARF_-P	18/03/03 00/00/00	
OR	996263	ORIFIZIO N°01 ODF DANFOSS N.01 ORIFICE ODF DANFOSS	AP_-P • AF_-P • ARF_-P • AF_VTR-P	05/04/04 00/00/00	
P	995240	PRESSOSTATO KP 5 AUTOMATICO HP KP 5 PRESSURE SWITCH AUTOMATIC HP		17/11/05 00/00/00	●
P/W	935984	CAVO CON PORTALAMPADA AR7/14 PLANET CABLE + BULB SOCKET AR7/14 PLANET	AR_ • ARR_ • AP_ • ARP_ • AFP_ • AF_ • ARF_	07/10/04 00/00/00	
PC G	965648	PARACOLPO D=20,5 H=7,6 BUMPER D=20,5 H=7,6	AR_ • ARR_ • AR_VTR • AP_ • ARP_ • AFP_ • AF_ • ARF_ • AF_VTR	24/06/05 00/00/00	
PCE	935848	PANNELLO COPERTURA EVAP. AR PLANET PANEL COVERING EVAPORATOR PLANET CAB.	AR_ • ARR_ • AR_VTR • AP_ • ARP_ • AFP_ • AF_ • ARF_ • AF_VTR	15/11/04 00/00/00	
PI 1	935853	ASS.PIEDE INOX 2"TONDO H=115-180 AR NEW FOOT ASS. INOX 2"ROUND H=115-180CAB. NEW		17/11/04 00/00/00	
PI 8	965792	KIT PIEDINI H=45 PER ABB 051 KIT FOOT H=45 FOR BLAST CHILLER 051		15/04/08 00/00/00	
PI 9	965794	AS.PIEDE 1"PERNO M10 R.45-54 FOOT ASS. 1" PIN M10 R.45-54		15/04/08 00/00/00	
PL	935801	FIANCHETTO DX AR7 PLANET RIGHT LATERAL PANEL AR7 PLANET	AR7-14 • ARR142 • AR7-14VTR • AP7-14 • ARP142 • AFP142 • AF7-14 • ARF142 • AF7-14VTR	10/11/04 17/04/05	

referim. reference	codice code	descrizione description	modello model	da...a from...to	ricambi cons. rec. spare part
PL	935802	ASS. FIANCHETTO SX AR7 PLANET LEFT LATERAL PANEL AR7 PLANET	AR7-14 • ARR142 • AR7-14VTR • AP7-14 • ARP142 • AFP142 • AF7-14 • ARF142 • AF7-14VTR	10/11/04 17/04/05	
PL	935804	ASS. FIANCHETTO DX AR6 PLANET RIGHT LATERAL PANEL AR6 PLANET	AR6-12 • ARR122 • AR6-12VTR • AP6-12 • ARP122 • AFP122 • AF6-12 • ARF122 • AF6-12VTR	10/11/04 17/04/05	
PL	935805	ASS. FIANCHETTO SX AR6 PLANET LEFT LATERAL PANEL AR6 PLANET	AR6-12 • ARR122 • AR6-12VTR • AP6-12 • ARP122 • AFP122 • AF6-12 • ARF122 • AF6-12VTR	10/11/04 17/04/05	
PL	935907	FIANCHETTO DX AR7 PLANET RIGHT SIDE AR7 PLANET	AR7-14 • ARR142 • AR7-14VTR • AP7-14 • ARP142 • AFP142 • AF7-14 • ARF142 • AF7-14VTR	07/03/05 31/08/05	
PL	935908	FIANCHETTO SX AR7 PLANET LEFT SIDE AR7 PLANET	AR7-14 • ARR142 • AR7-14VTR • AP7-14 • ARP142 • AFP142 • AF7-14 • ARF142 • AF7-14VTR	07/03/05 31/08/05	
PL	935909	FIANCHETTO DX AR6 PLANET RIGHT SIDE AR6 PLANET	AR6-12 • ARR122 • AR6-12VTR • AP6-12 • ARP122 • AFP122 • AF6-12 • ARF122 • AF6-12VTR	18/04/05 31/08/05	
PL	935910	FIANCHETTO SX AR6 PLANET LEFT SIDE AR6 PLANET	AR6-12 • ARR122 • AR6-12VTR • AP6-12 • ARP122 • AFP122 • AF6-12 • ARF122 • AF6-12VTR	18/04/05 31/08/05	
PO_b	935041	ASS. PORTA MZ SCHIUMATA AR HALF DOOR FOR CABINETS	AR_ • ARR_ • AP_ • ARP_ • AFP_ • AF_ • ARF_	20/05/08 00/00/00	
PO_b	996350	***ASS.PORTA INT.SCHIUMATA AR ECO PLAN DOOR FOR PLANET CABINET ECO	AR_ • ARR_ • AP_ • ARP_ • AFP_ • AF_ • ARF_	03/02/06 00/00/00	
PO_b	996351	ASS.PORTA INT.SCHIUMATA AR DOOR FOR CABINETS	AR_ • ARR_ • AP_ • ARP_ • AFP_ • AF_ • ARF_	07/02/06 00/00/00	
PO_c	935803	ASS. PORTA INT.SCHIUM. PLANET DOOR FOR PLANET CABINETS	AR_ • ARR_ • AP_ • ARP_ • AFP_ • AF_ • ARF_	10/11/04 00/00/00	
PO ½_c	935809	ASS.PORTA 1/2 SUP SCHIUM.PLANET HALF UPPER DOOR PLANET	AR_ • ARR_ • AP_ • ARP_ • AFP_ • AF_ • ARF_	10/11/04 00/00/00	
PO ½_c	935810	ASS.PORTA 1/2 SCHIUM.INF.DX C/SERR PLANET HALF RIGHT LOWER DOOR WITH LOCK PLANET	AR_ • ARR_ • AP_ • ARP_ • AFP_ • AF_ • ARF_	10/11/04 00/00/00	
PO ½_c	935811	ASS.PORTA 1/2 SCHIUM.INF.SX C/SERR PLA HALF LEFT LOWER DOOR WITH LOCK PLANET	AR_ • ARR_ • AP_ • ARP_ • AFP_ • AF_ • ARF_	10/11/04 00/00/00	
PO ½_b	935042	ASS.PO.MZ SCHIUMATA DX C/SERRATURA HALF RIGHT DOOR WITH LOCK	AR_ • ARR_ • AP_ • ARP_ • AFP_ • AF_ • ARF_	20/05/08 00/00/00	
PO ½_b	935043	ASS.PO.MZ.SCHIUMATA SX C/SERRATURA HALF LEFT DOOR WITH LOCK	AR_ • ARR_ • AP_ • ARP_ • AFP_ • AF_ • ARF_	20/05/08 00/00/00	
kit PO V dx	935860	PORTA VETRO TN DX AR PLANET RIGHT GLASS DOOR FOR PLANET TN CABINET	AR_VTR	12/03/06 00/00/00	
kit PO V sx	935861	PORTA VETRO TN SX AR PLANET RIGHT GLASS DOOR FOR PLANET TN CABINET	AR_VTR	12/03/06 00/00/00	
kit PO V dx	935862	PORTA VETRO BT 3VTR RISC.DX AR PLANET RIGHT 3-GLASS DOOR BT WARMED PLANET CAB.	AF_VTR	21/03/06 00/00/00	
kit PO V sx	935863	PORTA VETRO BT 3VTR RISC.SX AR PLANET LEFT 3-GLASS DOOR BT WARMED PLANET CAB.	AF_VTR	12/03/06 00/00/00	
PR 3	935855	ASS.RUOTA CON FRENO AR PLANET/STAR REV.CASTOR WITH BRAKES PLANET/STAR CAB.	AR_ • ARR_ • AR_VTR • AP_ • ARP_ • AFP_ • AF_ • ARF_ • AF_VTR	17/11/04 19/09/07	
	996600	RUOTA GIR D=100 3477PJO100/30P62 C/F P REV.CASTOR WITH B. D=100 3477PJO100/30P62		20/09/07 00/00/00	
PR 4	935854	RUOTA GIREVOLE S/FRENO AR PLANET/STAR REV.CAS. WITHOUT BRAKES PLANET/STAR CAB.	AR_ • ARR_ • AR_VTR • AP_ • ARP_ • AFP_ • AF_ • ARF_ • AF_VTR	17/11/04 19/09/07	
	996599	RUOTA GIR D=100 3470PJO100/30P62 S/F P R.CAS. WITHOUT BR. D=100 3470PJO100/30P62		20/09/07 00/00/00	
PVE	995776	ASS.SEMIPROT.VALVOLA 'FLICA-DANFOSS' SEMI-PROTECTION VALVE 'FLICA/DANFOSS'	AR_-P • ARR_-P • AR_VTR-P • AP_-P • ARP_-P • AFP_-P • AF_-P • ARF_-P • AF_VTR-P	13/06/97 00/00/00	
Q	996017	RELE' AVVIAMENTO DANFOSS '117U6003' STARTING RELAY DANFOSS '117U6003'	> 995743	21/11/03 12/03/06	●
	996549	RELE' AVVIAMENTO DANFOSS '117U6022' STARTING RELAY DANFOSS '117U6022'	> 995743 > 996355	13/03/06 00/00/00	●
Q	996020	RELE' AVVIAMENTO DANFOSS '117U6015' STARTING RELAY DANFOSS '117U6015'	> 995740	22/05/00 05/11/06	●
Q	996021	RELE' AVVIAMENTO DANFOSS '117U6019' STARTING RELAY DANFOSS '117U6019'	> 995745 > 996725	22/05/00 12/09/08	●

riferim. reference	codice code	descrizione description	modello model	da...a from...to	ricambi cons. rec. spare part
Q	996548	RELE' AVVIAMENTO DANFOSS '117U6016' STARTING RELAY DANFOSS '117U6016'	> 996353	06/11/06 13/05/07	●
Q	996751	RELE' AVVIAMENTO DANFOSS '117U6013' STARTING RELAY DANFOSS '117U6013'	> 996724	11/06/08 00/00/00	●
Q	996763	RELE' AVVIAMENTO ACC '127S-8' STARTING RELAY ACC '127S-8'	> 996592	14/05/07 00/00/00	●
R1	935849	RES.BATT.GUARN.PORTA 31W PLANET/STAR FRAME RESISTANCE DOOR 31W PLANET/STAR	AR_ • ARR_ • AR_VTR • AP_ • ARP_ • AFP_ • AF_ • ARF_ • AF_VTR	15/11/04 00/00/00	●
R1	935850	RES.BAT.GUARN.P.1/2 41W PLANET/STAR FRAME RESIST. HALF DOORS 41W PLANET/STAR	AR_ • ARR_ • AP_ • ARP_ • AFP_ • AF_ • ARF_	15/11/04 00/00/00	
R2	935871	RES.SBRIN.230V 350W AR6/7 PLANET DEFROSTING RESIST. 230V 350W AR6/7 PLANET	AR6-7 • ARR122 • AR6-7VTR • AP6-7 • ARP122 • AFP122 • AF6-7 • ARF122 • AF6-7VTR	01/07/05 00/00/00	●
R2	935874	RES.SBRIN.230V 700W AR12/14 PLANET DEFROSTING RES. 230V 700W AR12/14 PLANET	AR12-14 • ARR142 • AR12-14VTR • AP12- 14 • ARP142 • AFP142 • AF12-14 • ARF142 • AF12-14VTR	16/11/04 00/00/00	●
R3	935875	CARTUCCIA RIS.AR PLANET PTC 90W 230/26 HEATER PTC 90W 230/26 PLANET CABINETS	AR_-P • ARR_-P • AR_VTR-P • AP_-P • ARP_-P • AFP_-P • AF_-P • ARF_-P • AF_VTR-P	28/11/06 00/00/00	
RL	995161	RICEVITORE DI LIQUIDO 0,85 LITRI LIQUID RECEIVER 0,85 LITERS	AR12-14VTR	22/02/05 00/00/00	
S/R3	936662	SUPPORTO RESISTENZA AR PLANET PREDISP. RESIST. SUPPORT PLANET CAB. WITHOUT R.U.	AR_-P • ARR_-P • AR_VTR-P • AP_-P • ARP_-P • AFP_-P • AF_-P • ARF_-P • AF_VTR-P	28/11/06 00/00/00	
SCE	935985	ASS.SCATOLA ELETTR.AR7/14 PLANET ELECTRIC BOX ASS. AR7/14 PLANET	AR_ • ARR_ • AR_VTR • AP_ • ARP_ • AFP_ • ARF_	17/04/05 00/00/00	
SCE	996657	ASS.SCATOLA ELETTR.AF7/14 PLANET ELECTRIC BOX ASS. AF7/14 PLANET	AFP_ • AF_ • ARF_ • AF_VTR	18/04/05 00/00/00	
TEC	936663	SERP.EVAP.ACQUA DI SRIN.AF7/14 PLANET COIL PIPE EVAP. DEFROST WATER AF7/14 PL.	AF_ • AF6-7VTR • ARF_ • AFP122	22/07/04 00/00/00	
TEC	935986	SERPENT.EVAP.ACQUA DI SBRIN. AR PLANET COIL PIPE EVAP.DEFROST WATER PL.CAB.	AR_ • AR_VTR • ARR_ • AP_ • ARP122 • ARF_ • AFP122	22/07/04 00/00/00	
TEC	935987	SERP.EVAP.ACQUA Sbrin.AF7/14 VTR PLAN. COIL PIPE EVAP. DEFROST WATER AF GLAS.	AF12-14VTR	09/05/05 00/00/00	
TG 1-2	996148	TUBO FLEX GOMMA+CALZA 3/8M-1/2F L=200 FLEX PLAST. TUBE+BRAIDING 3/8M-1/2F L=200		09/05/02 00/00/00	
TR	935642	ASS.TRAVERS.SCHIUM. AR7 2MZ.PORTE PLANET CROSSBEAM HALF DOOR AR7 PLANET	AR_ • ARR_ • AP_ • ARP_ • AFP_ • AF_ • ARF_	30/07/08 00/00/00	
TS	935676	ASS.SCAMB. TUBO 10X1 CAP.1,24X3000 EXCHANGER TUBE 10X1 CAP.1,24X3000	AF12-14	23/04/02 00/00/00	
TS	935680	SCAMBIATORE 1,24X4000 AF6/7 R22/R404A EXCHANGER TUBE 1,24X4000 AF6/7 R22/R404A	AFP_ • AF6-7 • ARF_ • AF_VTR	05/09/01 00/00/00	
TS	996222	ASS.SCAMB.8X1 CAP.1.24X3000 AR6/7 EXCHANGER TUBE 8X1 CAP.1.24X3000 AR6/7	AR_ • ARR_ • AR_VTR • AP_ • ARP_ • AFP_ • ARF_	19/06/03 00/00/00	
TS	935988	ASS.RITORNO/SCAMB. AF14 VTR BT PLANET EXCHANGER TUBE AF14 GL. BT PLANET	AF12-14VTR	22/02/05 00/00/00	
TSC	935989	TUBO SCARICO ACQUA DI SBRIN. AR PLANET DRAIN TUBE WATER DEFROST PLANET CABINETS	AR_ • ARR_ • AR_VTR • AP_ • ARP_ • AFP_ • AF_ • ARF_ • AF_VTR	27/10/04 00/00/00	
V/W	935357	VETRINO PROTEZIONE LAMPADA AR MNSC GLASS TO PROTECT LAMP MNSC CABINETS	AR_ • ARR_ • AP_ • ARP_ • AFP_ • AF_ • ARF_	01/01/95 00/00/00	
V1	995336	VALVOLA SOLENOIDE 1/4"A SALDARE 230V SOLENOID VALVE 1/4" TO SOLD 230V	AF12-14VTR	22/02/05 00/00/00	
VE	996205	VALV.TN2 68Z3384 ODF -40+10 S/MOP R134 TH. VALVE TN2 68Z3384 ODF-40+10 S/MOP R134	AR_-P • ARR_-P • AR_VTR-P • AP_-P • ARP_-P • AFP_-P • ARF_-P	18/03/03 00/00/00	●
VE	996206	VALVOLA TERMOSTATICA TS2 R404A SALDARE THERMOSTATIC VALVE TS2 R404A TO SOLD	AF_-P • ARF_-P • AF_VTR-P	18/03/03 00/00/00	●
VE	996259	VALV.TES2 68Z3648 ODF -40-15 MOP-10 R4 TH.VALVE TES2 68Z3648 ODF -40-15 MOP-10 R4	AF12-14VTR-P	22/02/05 08/09/04	●
VP	995492	VALVOLA PRESSOSTATICA DA 3/8 ACQUA PRESSURE VALVE 3/8 WATER		17/11/05 00/00/00	
W	935883	AS.LAMP FLU.230V 28W LYVIA LNK.28 6400 FLUORESC. LAMP 230V 28W LYVIA LNK.28 6400	AR_VTR • AF_VTR	17/11/04 00/00/00	
W	995412	LAMPADA TUBOLARE 10W E14 AR MNSC TUBULAR LAMP 10W E14 AR MNSC	AR_ • ARR_ • AP_ • ARP_ • AFP_ • AF_ • ARF_	01/01/95 00/00/00	