

**RECAMBIOS  
MEP-100 G**

24/09/2008



F A G O R I

COD. 148513100000

| N. | CODIGO     | DENOMINACION                         | CANTIDAD |
|----|------------|--------------------------------------|----------|
| 1  | 6003010326 | DESAG COMPL 3/4 GRIS+TUERCA          | 1        |
| 2  | 6003010262 | TAPON DESAGÜE DE 3/4 CIEGO           | 1        |
| 3  | 6003010327 | JUNTA GOMA DESAGÜE 3/4               | 1        |
| 4  | M181010572 | ENCIMERA MEP100 C/CUPULA(COMPLETA)   | 1        |
| 5  | 6035050057 | CRISTAL MEP100 888x149x4 CUP.        | 1        |
| 6  | 6035050058 | CRISTAL MEP100 888x174x6 CUP.        | 1        |
| 7  | M107130007 | PERFIL UNION CRIST.MEP-100           | 2        |
| 8  | 6007050095 | PATA REGULAB D-63x90/115 MEP100      | 4        |
| 9  | 6025050010 | TORN 4.8x25 ZINC DIN 7981            | 16       |
| 10 | M169010119 | PUERTA MEP-100 IZDA FAGOR            | 1        |
| 11 | 6045010152 | BURLETE CAJON MFP 2/3                | 2        |
| 12 | 6003010136 | CAJA ALOJAMIENTO MUELLE GRIS         | 2        |
| 13 | 6033010100 | BIS.TRS1D DOBL MUELLE DV-2608        | 2        |
| 14 | M169090003 | JGO.BISAG.APERT.IZDA MSP COMPLETO    | 1        |
| 15 | M169090004 | JGO.BISAG. APERTURA. DCHA            | 1        |
| 16 | 6033010099 | SOP.BISAG. DV2606 INF DCHA           | 1        |
| 17 | M169010120 | PUERTA MEP-100 DCHA FAGOR            | 1        |
| 18 | 6033090064 | EJE30x10VARIL INOX ROSC.INT M6       | 2        |
| 19 | M109050627 | OMEGA CONTRAF. MEP100                | 1        |
| 20 | 6023010418 | PEGATINA 105x220 CUADRO REMOTO FAGOR | 1        |
| 21 | M173010127 | UD.CONDENS.MEP-100                   | 1        |
| 22 | 6021010004 | COMPR.FR-7,5-G R134A                 | 1        |
| 23 | 6029020002 | CONDENSADOR 9x2                      | 1        |
| 24 | 6021050002 | VENTILADOR 10W PATA PALA 220V        | 1        |
| 25 | 6021310003 | VALVULA OBUS COMPLETA RF.HB-1S       | 1        |
| 26 | 6047010003 | FILTRO DESHIDRAT.40GR 1/4X1/4        | 1        |
| 27 | M109050630 | SOP. SUP. PUERTAS MEP-100            | 1        |
| 28 | 6003010023 | BANDEJA EVAP. AUTOMÁTICA             | 1        |
| 29 | M109250127 | OMEGA COND.9X2-REJ.MESAS-ARMAR       | 1        |
| 31 | 6021130001 | INT.BIP.AMB.O/I CONTAC.REFORZ.       | 1        |
| 32 | 6021350018 | TERMOS REFRI CAREL PYCO1RN515        | 1        |

|    |            |                                    |   |
|----|------------|------------------------------------|---|
| 33 | 6021450039 | INST.ELECTRICA MEP-100             | 1 |
| 34 | M171010096 | UD.EVAPORAT.MEP-100                | 1 |
| 35 | 6029010113 | BAT.6T3R330A4S18TD10 SAL.310 PINT. | 1 |
| 37 | M109010960 | REJ. TRASERA MEP-100               | 2 |
| 39 | 6003010062 | DESA.1/2 PULG. LARGO+TUERC         | 1 |
| 41 | 6027010003 | PARRILLA GN. 1/1 530x325           | 2 |
| 42 | 6039010008 | JGO.COST.METACRI. MEP-100          | 1 |
| 43 | 6021050008 | VENTILADOR 120x120 CON BOLAS       | 2 |
| 44 | M109050015 | BANDEJA GOTEIO MEP-100             | 1 |
| 45 | 6033010098 | SOP.BISAG.DV2607 INF IZQ.          | 1 |
| 46 | 6025090027 | TORN M6X10 INOX EXAGONAL           | 4 |
| 47 | 6025050073 | TORN.4.8X32 INOX DIN 7982          | 6 |
| 48 | M109050619 | COSTADO EVAP. IZDA. MEP-100        | 1 |
| 49 | 6003010068 | PISACABLES DE 90°                  | 1 |
| 50 | 6021390006 | MANG 3X1X2500 BL. SCHUKO 3T        | 1 |
| 51 | 6007170097 | PERFIL EN U A 336 MM/90°           | 4 |
| 52 | M109050625 | CREMALL. MARCO MEP-100             | 4 |
| 53 | 6025210009 | ARANDELA ALA ANCHA M6 INOX         | 4 |
| 54 | M109050618 | COSTADO EVAP. DCHA. MEP-100        | 1 |
| 55 | M109050622 | CREMALLERA INT. DCHA. MEP-100      | 1 |
| 56 | M109050623 | CREMALLERA INT. IZDA. MEP-100      | 1 |
| 57 | M109050626 | OMEGA RESPALDO. MEP-100 2006       | 1 |
| 58 | M109050629 | TAPA CAJA EVAP. MEP-100            | 1 |
| 59 | 6033050015 | GUIA SNACK.DT.CONG-MESA GN 562mm   | 8 |
| 60 | A107010075 | TUB.EVAP.AUT. AFP-700,MEP100       | 1 |
| 61 | 6031010058 | ENCIMERA MARMOL915x440x20          | 1 |

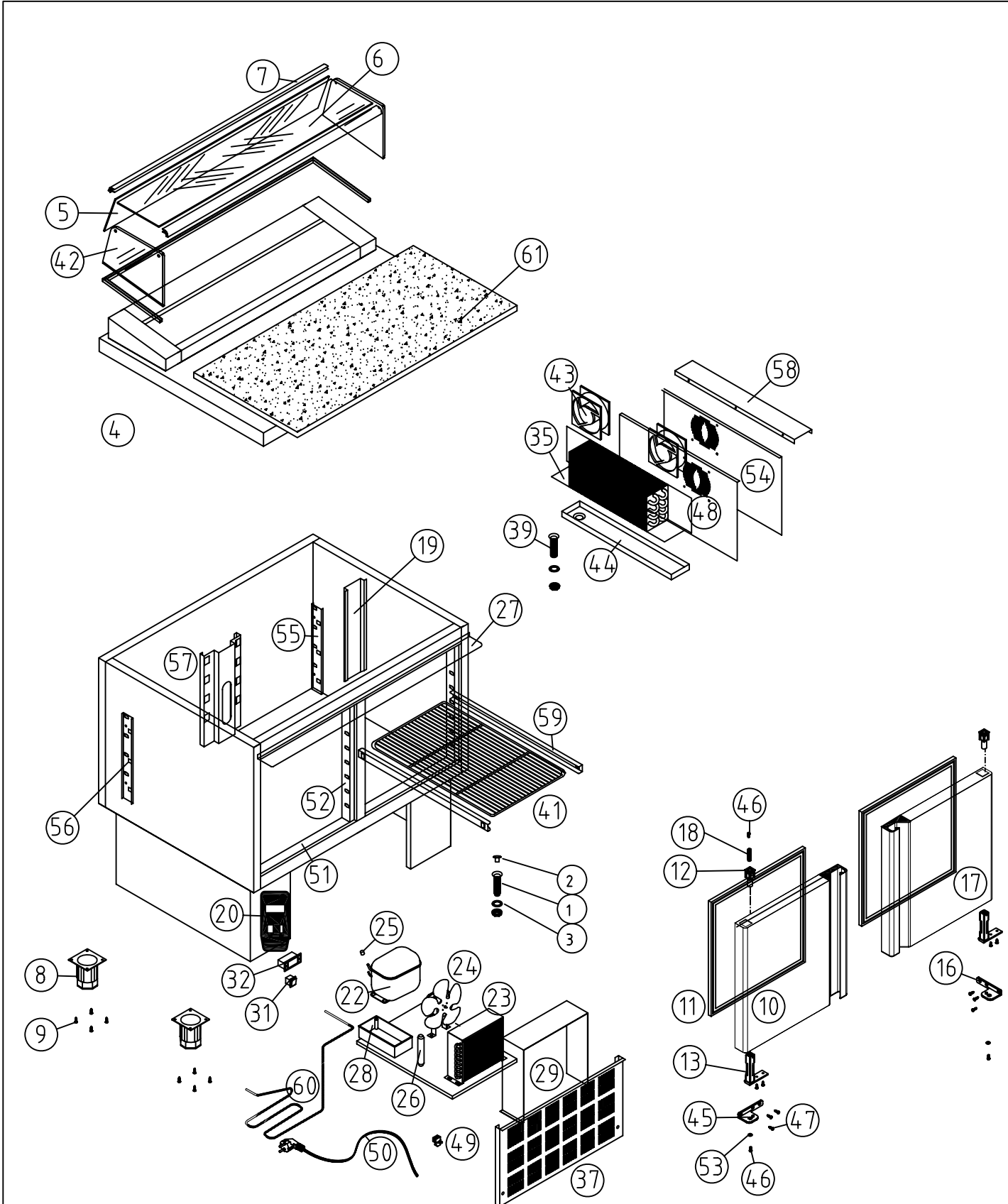

|                                 |                     |       |       |                     |                          |     |        |     |                 |            |        |     |        |     |
|---------------------------------|---------------------|-------|-------|---------------------|--------------------------|-----|--------|-----|-----------------|------------|--------|-----|--------|-----|
| M1 MESA SANDWICHES              |                     |       |       |                     | COD. PIEZA: 148513100000 |     |        |     |                 |            |        |     |        |     |
| COTAS SIN TOLERANCIA DIN 7168-f |                     |       |       |                     | Material:                |     |        |     |                 |            |        |     |        |     |
| ANGULAR                         | GRADO TOLERANCIA    | FINO  | MEDIO | GRUESO              | Acabado:                 |     |        |     |                 |            |        |     |        |     |
|                                 | HASTA 10 mm         |       | ±1°   | ±1° 30'             | SUSTITUYE A:             |     |        |     |                 |            |        |     |        |     |
|                                 | MÁS DE 10 A 50 mm   | ±30'  |       | ±50'                | SUSTITUIDO POR:          |     |        |     |                 |            |        |     |        |     |
|                                 | MÁS DE 50 A 120 mm  | ±20'  |       | ±25'                | COMUN A                  |     |        |     |                 |            |        |     |        |     |
|                                 | MÁS DE 120 A 400 mm | ±10'  |       | ±15'                | MODELO                   | Ud. | MODELO | Ud. | MODELO          | Ud.        | MODELO | Ud. | MODELO | Ud. |
| MÁS DE 400 mm                   | ±5'                 |       | ±10'  | MEP-100 G           | 1                        |     |        |     |                 |            |        |     |        |     |
| LINEAL                          | GRADO TOLERANCIA    | FINO  | MEDIO | GRUESO              | A4                       |     |        |     |                 | Nombre     |        |     |        |     |
|                                 | HASTA 3 mm          | ±0,05 | ±0,10 | ±0,15               | Dibujado                 |     |        |     |                 | Fecha      |        |     |        |     |
|                                 | MÁS DE 3 A 6 mm     | ±0,05 | ±0,10 | ±0,20               | JJVM                     |     |        |     |                 | 24/09/2008 |        |     |        |     |
|                                 | MÁS DE 6 A 30 mm    | ±0,10 | ±0,20 | ±0,50               | Modificado               |     |        |     |                 |            |        |     |        |     |
|                                 | MÁS DE 30 A 120 mm  | ±0,15 | ±0,30 | ±0,80               | Escala                   |     |        |     |                 | 1:20       |        |     |        |     |
| MÁS DE 120 A 400 mm             | ±0,20               | ±0,50 | ±1,20 | RECAMBIOS MEP-100 G |                          |     |        |     | Código máquina: |            |        |     |        |     |
| MÁS DE 400 A 1000 mm            | ±0,30               | ±0,80 | ±2,00 |                     |                          |     |        |     | CODIGO          |            |        |     |        |     |
| MÁS DE 1000 A 2000 mm           | ±0,50               | ±1,20 | ±3,00 |                     |                          |     |        |     |                 |            |        |     |        |     |



F A G O F R I