

M1 MESAS FRÍAS

COD. PIEZA:
SUSTITUYE A:
SUSTITUIDO POR:

COTAS SIN TOLERANCIA DIN 7168-f

Material: **MATERIAL ESPESOR**

Acabado: **ACABADO**

| ANGULAR | GRADO TOLERANCIA | FINO | MEDIO | GRUESO |
|---------------------|------------------|------|-------|--------|
| | HASTA 10 mm | | ±1° | |
| MAS DE 10 A 50 mm | | ±30' | | ±50' |
| MAS DE 50 A 120 mm | | ±20' | | ±25' |
| MAS DE 120 A 400 mm | | ±10' | | ±15' |
| MAS DE 400 mm | | ±5' | | ±10' |

| COMÚN A | MODELO | Ud. | MODELO | Ud. | MODELO | Ud. | MODELO | Ud. | MODELO |
|---------|--------|---------|--------|-----|--------|-----|--------|-----|--------|
| | | MPN-202 | 1 | | | | | | |

| LINEAL | GRADO TOLERANCIA | FINO | MEDIO | GRUESO |
|-----------------------|------------------|-------|-------|--------|
| | HASTA 3 mm | | ±0,05 | ±0,10 |
| MAS DE 3 A 6 mm | | ±0,05 | ±0,10 | ±0,20 |
| MAS DE 6 A 30 mm | | ±0,10 | ±0,20 | ±0,50 |
| MAS DE 30 A 120 mm | | ±0,15 | ±0,30 | ±0,80 |
| MAS DE 120 A 400 mm | | ±0,20 | ±0,50 | ±1,20 |
| MAS DE 400 A 1000 mm | | ±0,30 | ±0,80 | ±2,00 |
| MAS DE 1000 A 2000 mm | | ±0,50 | ±1,20 | ±3,00 |

A4 Nombre Fecha
Dibujado MJGG 3-3-03
Modificado .



Escala 1:22

RECAMBIOS MPN

Código máquina:
CODIGO

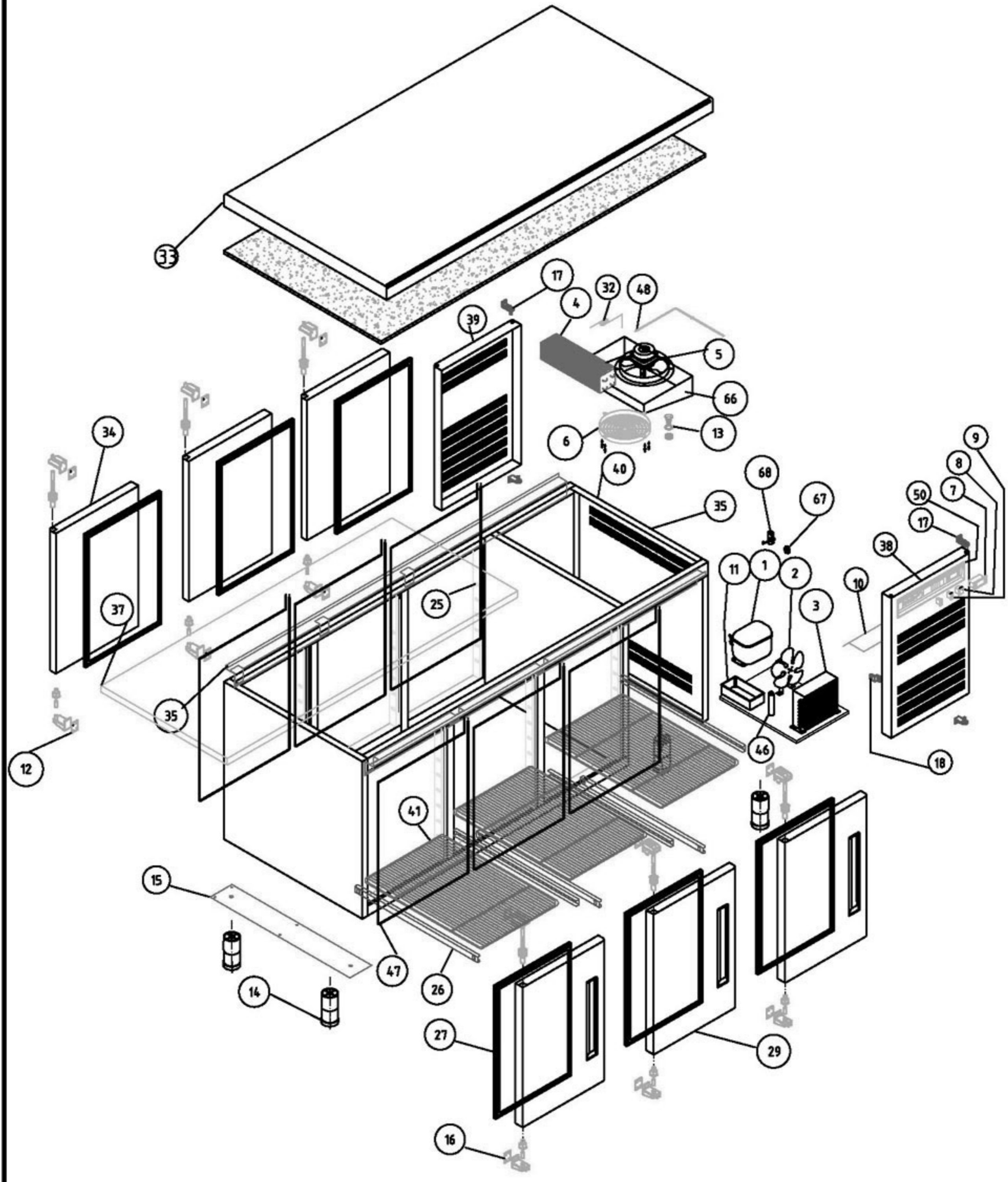

| | | | | | | | | | | | | | | |
|---------------------------------|---------------------|-------|-------|---------|----------------------------|---------------|--------|-----------|-------|----------------------------------|------------------------------|--------|-----|--------|
| M1 MESAS FRÍAS PASTELERÍA | | | | | COD. PIEZA: X | | | | | | | | | |
| COTAS SIN TOLERANCIA DIN 7168-f | | | | | Material: MATERIAL ESPESOR | | | | | | | | | |
| | | | | | Acabado: ACABADO | | | | | | | | | |
| ANGULAR | GRADO TOLERANCIA | FINO | MEDIO | GRUESO | COMÚN A | MODELO | Ud. | MODELO | Ud. | MODELO | Ud. | MODELO | Ud. | MODELO |
| | HASTA 10 mm | | ±1° | ±1° 30' | | MPN-202-C | 1 | | | | | | | |
| | MAS DE 10 A 50 mm | | ±30' | ±50' | | | | | | | | | | |
| | MAS DE 50 A 120 mm | | ±20' | ±25' | | | | | | | | | | |
| | MAS DE 120 A 400 mm | | ±10' | ±15' | | | | | | | | | | |
| MAS DE 400 mm | | ±5' | ±10' | | | | | | | | | | | |
| LINEAL | GRADO TOLERANCIA | FINO | MEDIO | GRUESO | A4 | | Nombre | | Fecha | | FAGOR FAGOFRI s.a. | | | |
| | HASTA 3 mm | | ±0,05 | ±0,10 | ±0,15 | Dibujado MJGG | | . 14-3-03 | | | | | | |
| | MAS DE 3 A 6 mm | | ±0,05 | ±0,10 | ±0,20 | Modificado | | | | | | | | |
| | MAS DE 6 A 30 mm | | ±0,10 | ±0,20 | ±0,50 | Escala | | | | Código máquina: CODIGO | | | | |
| | MAS DE 30 A 120 mm | | ±0,15 | ±0,30 | ±0,80 | 1:25 | | | | | | | | |
| | MAS DE 120 A 400 mm | | ±0,20 | ±0,50 | ±1,20 | | | | | | | | | |
| MAS DE 400 A 1000 mm | | ±0,30 | ±0,80 | ±2,00 | | | | | | | | | | |
| MAS DE 1000 A 2000 mm | | ±0,50 | ±1,20 | ±3,00 | | | | | | | | | | |

RECAMBIOS MPN-CENTRAL

RECAMBIOS MESAS FRÍAS

revisión 01-03-2003



FAGOFRI S.A.

MODELOS

| Nº | CÓDIGO | DESCRIPCIÓN | MPN-150-C | MPN-202-C | MPN-255-C | MPN-307-C | MPN-117-C | MPN-169-C | MPN-222-C | MPN-274-C |
|----|------------|--|------------|-----------|-----------|-----------|-----------|-----------|-----------|-----------|
| | | | PASTELERAS | | | | | | | |
| 1 | 6021010001 | COMPR.SC-12-CL R404A | 1 | | | | | | | |
| 1 | 6021010002 | COMPR.SC-15-CL R404A | | 1 | | | | | | |
| 1 | 6021010006 | COMPR.J-2192-GK R404A ASPERA | | | 1 | 1 | | | | |
| 2 | 6021050002 | VENTILADOR 10W PATA PALA 220V | 1 | 1 | 1 | 1 | | | | |
| 3 | 6029020005 | CONDENSADOR 10x4 TECHO | 1 | 1 | | | | | | |
| 3 | 6029020019 | CONDENSADOR 20X4 BAFLE | | | 1 | 1 | | | | |
| 4 | 6029010025 | EV.CONG.FC71B BAJO MSN250 | | | 1 | 1 | | | | |
| 4 | 6029010037 | BAT.FC61B BAJO6T4R300A6S(PINTA | 1 | 1 | | | | | | |
| 4 | M129010002 | BAT.MFP135 5T4R330A4SC/TUB(PIN | | | | | 1 | 1 | 1 | 1 |
| 5 | 6021050001 | VENTIL.EVAPOR.5W ARO/TIRO FORZ | 1 | 1 | 1 | 1 | 1 | 1 | 1 | 1 |
| 6 | 6003010035 | REJILLA PROTECCION VENTILADOR | 1 | 1 | 1 | 1 | 1 | 1 | 1 | 1 |
| 7 | 6021350015 | TERMOSTATO TERM.REFRIG ID 961F | 1 | 1 | 1 | 1 | 1 | 1 | 1 | 1 |
| 8 | 6021130001 | INTERRUPTOR BIPOL.AMB.ON/OFF | 1 | 1 | 1 | 1 | 1 | 1 | 1 | 1 |
| 9 | 6021130010 | PILOTO RECTAN.AMBAR SEÑAL LUM. | 1 | 1 | 1 | 1 | 1 | 1 | 1 | 1 |
| 10 | M109050157 | CHAPA PROT.MANDOS MESAS FRIAS | 1 | 1 | 1 | 1 | | | | |
| 11 | 6003010023 | BANDEJA EVAPORACION AUTOMÁTICA | 1 | 1 | 1 | 1 | | | | |
| 12 | V169090002 | BISAGRA SISTEMA GIRO A DCHA | 2 | 3 | 4 | 5 | 2 | 3 | 4 | 5 |
| 13 | 6003010034 | DESAGÜE SAN MIGUEL | 1 | 1 | 1 | 1 | 1 | 1 | 1 | 1 |
| 14 | 6007050015 | PATA REGUL. 50X95 BAJOS | 4 | 4 | 4 | 4 | 4 | 4 | 4 | 4 |
| 15 | M161250007 | BASE PATAS MPP 700X100 PINTADA | 1 | 1 | 1 | 1 | 1 | 1 | 1 | 1 |
| 16 | V169090001 | BISAGRA SISTEMA GIRO A IZDA | 2 | 3 | 4 | 5 | 2 | 3 | 4 | 5 |
| 17 | 6003010048 | SOPORTE PUERTA REJILLA | 4 | 4 | 4 | 4 | | | | |
| 18 | 6003010032 | ESCUADRA AMARRE REJILLA | 2 | 2 | 2 | 2 | | | | |
| 25 | M109050156 | CREMALLERA MPP 577X70 | 8 | 12 | 16 | 20 | 8 | 12 | 16 | 20 |
| 26 | 6033050013 | GUIA PAST.CENTRAL EN L 705mm | 8 | 12 | 16 | 20 | 8 | 12 | 16 | 20 |
| 27 | 6045010009 | BURLETE 475X605 MSP | 4 | 6 | 8 | 10 | 4 | 6 | 8 | 10 |
| 29 | M169010010 | PUERTA MSP/MPP IZDA TIR.ABS | 4 | 3 | 4 | 5 | 2 | 3 | 4 | 5 |
| 32 | V107020005 | CAPILAR 1.25x2100 | | | 1 | 1 | | | | |
| 32 | M107020001 | CAPILAR 1x3300 | 1 | 1 | | | | | | |
| 33 | M181010042 | ENCIMERA MPP274C | | | | | | | | 1 |
| 33 | M181010041 | ENCIMERA MPP222C | | | | | | | 1 | |
| 33 | M181010040 | ENCIMERA MPP169C | | | | | | 1 | | |
| 33 | M181010039 | ENCIMERA MPP117C | | | | | 1 | | | |
| 33 | M181010038 | ENCIMERA MPP300C | | | | 1 | | | | |
| 33 | M181010037 | ENCIMERA MPP250C | | | 1 | | | | | |
| 33 | M181010036 | ENCIMERA MPP200C | | 1 | | | | | | |
| 33 | M181010035 | ENCIMERA MPP150C | 1 | | | | | | | |
| 34 | M169010016 | PUERTA MFN DCHA TIR.ABS | 2 | 3 | 4 | 5 | 2 | 3 | 4 | 5 |
| 35 | M109250056 | PROTECT. ENCIM. CENT. 250 IZD | | | 1 | 1 | | | 1 | 1 |
| 35 | M109250053 | PROTECT. ENCIM. CENT. 250 | | | 1 | 1 | | | 1 | 1 |
| 35 | M109250055 | PROTECT. ENCIM. CENT. 200 IZD | | 1 | | | | 1 | | |
| 35 | M109250052 | PROTECT. ENCIM. CENT. 200 | | 1 | | 1 | | 1 | | 1 |
| 35 | M109250054 | PROTECT. ENCIM. CENT. 150 IZD | 1 | | | | 1 | | | |
| 35 | M109250051 | PROTECT. ENCIM. CENT. 150 | 1 | | | | 1 | | | |
| 36 | 6001050065 | AGLOM. 1490x830x13 ENC.MPP-150C | 1 | | | | 1 | | | |
| 36 | 6001050024 | AGLOM. 2540X770X13 ENC. MPP-255 | | | 1 | 1 | | | | |
| 36 | 6001050023 | AGLOM. 2010X770X13 ENC. MPP-202 | | 1 | | | | 1 | 1 | 1 |
| 37 | 6013050021 | PL.POLUEST.1010X666X30 TIPO IV | 1 | | | | 1 | | | |
| 37 | 6013050022 | PL.POLUEST.1535X666X30 TIPO IV | | 1 | 1 | 1 | | 1 | 1 | 1 |
| 38 | M109010343 | REJILLA CUADRO ABS GRIS MSN | 1 | 1 | 1 | 1 | | | | |
| 38 | M109010335 | CUADRO DE MANDOS MSN-R R7 | | | | | 1 | 1 | 1 | 1 |
| 39 | M109010353 | REJILLA TRAS CUAD REMOT MCP | | | | | 1 | 1 | 1 | 1 |
| 39 | M109010342 | REJILLA CUADRO TRASERA MCP-R7 | 1 | 1 | 1 | 1 | | | | |
| 40 | M109010194 | COST EXT LAD GRUP R MPP-R | | | | | 1 | 1 | 1 | 1 |
| 40 | M109010192 | COST EXT LADO GRUPO MPP | 1 | 1 | 1 | 1 | | | | |
| 41 | 6027010005 | PARRILLA PASTELERÍA 600X400 | 2 | 3 | 4 | 5 | 2 | 3 | 4 | 5 |
| 46 | 6047010003 | FILTRO DESHIDRAT.40GR 1/4X1/4 | 1 | 1 | 1 | 1 | | | | |
| 47 | 6021250002 | RESIST.MARCO SNACK-2, 21W | 2 | 4 | 6 | 8 | 2 | 4 | 6 | 8 |
| 47 | 6021250001 | RESIST.MARCO SNACK-1, 21W | 2 | 2 | 2 | 2 | 2 | 2 | 2 | 2 |
| 48 | 6021350013 | SONDA TERMOST.REF NTC 15KOhm | 1 | 1 | 1 | 1 | 1 | 1 | 1 | 1 |
| 50 | 6003010105 | CUADRO ABS GRIS | 1 | 1 | 1 | 1 | | | | |
| 55 | 6037050004 | SOPORTE COST.RODA.MPPR 230X700 | | | | | 1 | 1 | 1 | 1 |
| 66 | 6003050001 | GAVETA TIRO FORZADO GASTRO | 1 | 1 | 1 | 1 | | | | |
| 67 | 6021010050 | RELE ARRANQ.J2212GK 3ARR3B3AV37 | | | 1 | 1 | | | | |
| 67 | 6021010043 | RELE ARRANQUE COMPRESOR SC-15 CL 6019 | | 1 | | | | | | |
| 67 | 6021010042 | RELE ARRANQUE COMPRESOR SC-12 CL 6005 | 1 | | | | | | | |
| 68 | 6021010038 | CONDENS.ARRANQ. J2192GK 2252019 98microF | | | 1 | 1 | | | | |
| 68 | 6021010035 | CONDENS.ARRANQUE SC 117U5017 | 1 | 1 | | | | | | |